

**GoTECH UC81-OBF Front-Mount Cylinder**

# The most affordable hydraulic system



Transferrable link assembly – port or starboard to accommodate tight cowling clearances

304 Stainless Steel main cylinder rod for peak corrosion resistance



Machined aluminum bullhorns for enhanced durability

Split tilt tube rod for hassle free installation – no need to remove the engine

## Designed for Today's 115HP Engines

### Affordable steering for low- to mid-range-horsepower engines

Now that 4-stroke technology has reached the lower horsepower engines, even boats with 75, 90 and 115 hp engines are hard enough to steer to warrant hydraulic steering.

In the past, these lower horsepower engines required a system that was expensive and in many cases was not applicable because of the size of the cylinder relative to the cowling pan.

With the UC81 by Uflex, the boat will not only be significantly easier to steer than even the best mechanical steering, it will also be ZeroTorque feedback; locking out propeller torque with a 1,000 psi check valve.

Available as a package called GoTech which includes the UP18 Front Mount Helm, it is the perfect solution for boats with moderate steering loads.

### Key Features

- Lowest cost hydraulic steering solution on the market
- Specifically designed for 115 HP and under
- Mid-mount composite helm
- 4.5 turns lock to lock
- Perfect for low HP/high-torque applications such as pontoon boats
- Port or starboard link assembly mounting options

### Key Advantages

- Industry exclusive "Split Tilt Tube Rod" which allows you to install the cylinder without having to remove the engine
- Can be used as a port or starboard cylinder depending on your rigging needs



Starboard configuration



Port configuration



## UC81-OBF Specifications

MODEL	UC81-OBF
Volume	81 cc - 4.5 cu. in.
Output Force	222 kg - 489 lbs
Internal Diameter	27.4 mm - 1.08"
Stroke	186 mm - 7.3"
3/8" (9.5 mm) Fittings	For high-pressure flex hose
Bleed Fittings	DN5 Quick Connect

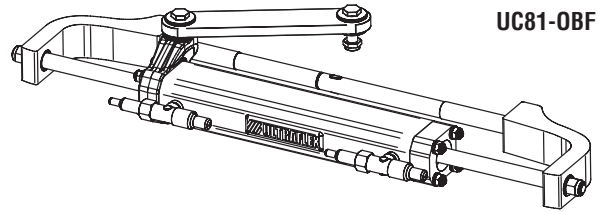

UC81-OBF

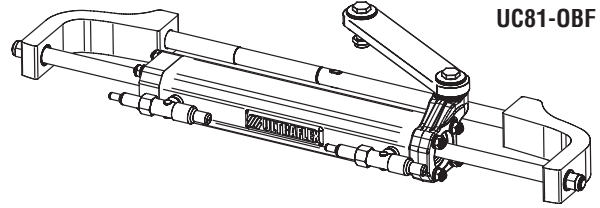

UC81-OBF

## Splashwell Dimensions Requirements

ENGINE NO.	A	B	C
1	22.05" (560 mm)	5.98" (152 mm)	5.98" (152 mm)

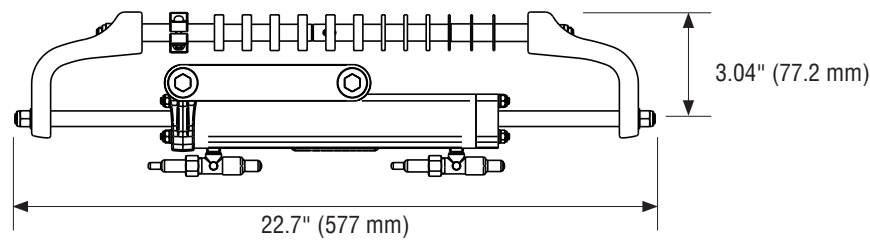

## UC81-OBF Front-Mount Cylinder Application Guide

ENGINE	POWER	YEAR	PACKAGED KIT	SINGLE CYLINDER
Evinrude	E40-E50-E55-E60 2 Stroke	2004-to date	Gotech 1.0	UC81-OBF
	E75-E90 2 Stroke	2004-to date	Gotech 1.0	UC81-OBF
	E115 2 Stroke V4	1995-to date	Gotech 1.0	UC81-OBF
Honda	BF40-50-60-75-90 4 Stroke	1995- to date	Gotech 1.0	UC81-OBF
	BF90 V-TEC 4 Stroke	2008-to date	Gotech 1.0	UC81-OBF
Johnson	BJ60-70 4 Stroke	2001-2007	Gotech 1.0	UC81-OBF
	BJ90-115 4 Stroke	2001-2007	Gotech 1.0	UC81-OBF
	J90-115 V4 2 Stroke	1995-2007	Gotech 1.0	UC81-OBF
Mercury Mariner	115 EFI 2 Stroke	1990-2007	Gotech 1.0	UC81-OBF
	40-50-60 EFI 4 Stroke	2004-to date	Gotech 1.0	UC81-OBF
	75-80-90 EFI 4 Stroke	2000-to date	Gotech 1.0	UC81-OBF
	100-115 EFI 4 Stroke	2007-to date	Gotech 1.0	UC81-OBF
Selva	Shark/St Tropez-70 Make Shark 2 Stroke	1995-2008	Gotech 1.0	UC81-OBF
	80 Portofino/Tigershark 2 Stroke	1995-2008	Gotech 1.0	UC81-OBF
	50-60 Dorado EFI 4 Stroke	1995-2008	Gotech 1.0	UC81-OBF
	100 EFI Marlin-115 EFI Narwhal	2000-to date	Gotech 1.0	UC81-OBF
Suzuki	DF40-40-60-70-80-90 4 Stroke	1998-to date	Gotech 1.0	UC81-OBF
	DF100-115 4 Stroke	1998-to date	Gotech 1.0	UC81-OBF
Tohatsu	40-50-60-70-90 2 Stroke	2004-to date	Gotech 1.0	UC81-OBF
	75-115 2 Stroke	2004-to date	Gotech 1.0	UC81-OBF
	40-50 TLDI 4 Stroke	2004-to date	Gotech 1.0	UC81-OBF
	70-90-115 TLDI 4 Stroke	2004-to date	Gotech 1.0	UC81-OBF
Yamaha	60-70 2 Stroke	1984-2008	Gotech 1.0	UC81-OBF
	75C-90 2 Stroke	1998-2008	Gotech 1.0	UC81-OBF
	115C 2 Stroke	1990-2008	Gotech 1.0	UC81-OBF
	F40G-F70 4 Stroke	2010-to date	Gotech 1.0	UC81-OBF
	F30-F40-F60-F75-F80 EFI 4 Stroke	1999-2007	Gotech 1.0	UC81-OBF
	F90-F100-F115 EFI 4 Stroke	1999-2007	Gotech 1.0	UC81-OBF
	F80-F100 4 Stroke	2000-to date	Gotech 1.0	UC81-OBF
	F115	2004-to date	Gotech 1.0	UC81-OBF
	F40D-F50F-F60C EFI 4 Stroke	2004-to date	Gotech 1.0	UC81-OBF

**WARNING:** These recommendations should be used as a general reference only. Final selection should be made with the assistance of a qualified installation technician. For any further information please contact our technical service.