

ComNav[®]

marine ltd

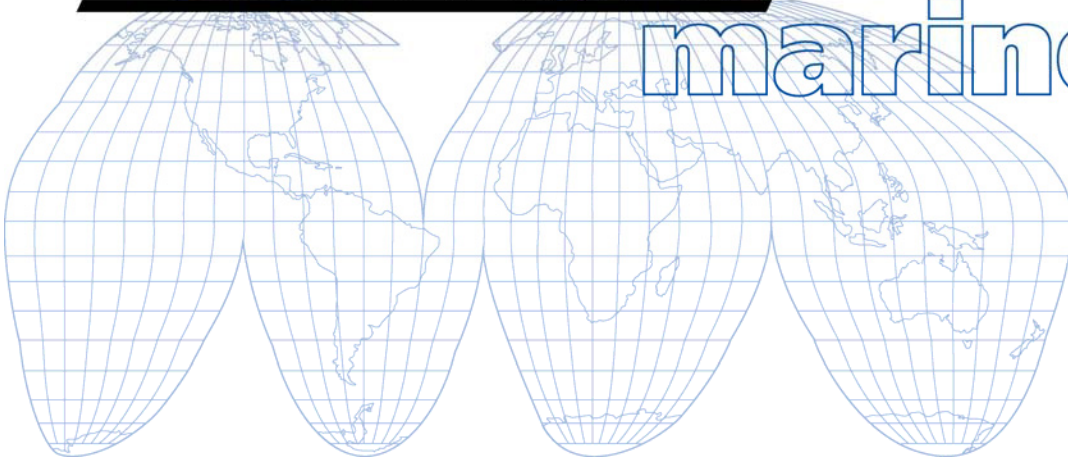

Vector G1 GPS

Satellite Compass

Installation & Operation Manual



ISO 9001

PN 29010087 v1.1



COMPLIES WITH
CE REGULATIONS

This device complies with part 15 of the FCC Rules. Operation is subject to the following two conditions:

- (1) This device may not cause harmful interference, and
- (2) this device must accept any interference received, including interference that may cause undesired operation.

Copyright Notice

No part of this manual may be reproduced, transmitted, transcribed, stored in a retrieval system or translated into any language or computer language, in any form or by any means, electronic, mechanical, magnetic, optical, chemical, manual or otherwise, without the prior written permission of ComNav Marine Ltd.

Chapter 1: Introduction

Overview

Parts List

Overview

Note: Throughout this manual, the Vector G1 GPS Compass is referred to simply as the G1.

The G1 is a complete GPS compass and positioning system in a single enclosure that requires only one power/data cable connection. With its CAN support and ease of installation, the G1 is the perfect solution for both marine and land base applications such as mine construction, earthworks and machine guidance.

The G1 is an integrated system that houses the following:

- Crescent Vector II technology
- Dual integrated GPS antennas
- Power supply
- Single axis gyro
- Tilt sensors (two)

The gyro and tilt sensors are present to improve system performance and to provide backup heading information in the event that a GPS heading is not available due to signal blockage.

Crescent technology supports multiple RF front ends - enabling tighter coupling of measurements from separate antennas for use in heading-based products. Users will achieve excellent accuracy and stability due to Crescent's more accurate code phase measurements, improved multipath mitigation, and fewer components.

The G1's GPS antennas are separated by 27 cm between their phase centers, resulting in better than 0.60° rms heading performance. The G1 provides heading and positioning updates of up to 20 Hz and delivers positioning accuracy of better than 1.0 m 95% of the time when using differential GPS corrections from Space Based Augmentation Systems (SBAS).

The G1 GPS receivers may utilize old differential GPS correction data for 40 minutes or more without significantly affecting the positioning quality. The G1 is less likely to be affected by differential signal outages due to signal blockages, weak signals, or interference when using COAST.

If you are new to GPS and SBAS, refer to the GPS Technical Reference for further information on these services and technologies before proceeding.

Parts List

Note: The G1's parts comply with IEC 60945 Section 4.4: "exposed to the weather."

Part Name	Qty	Part Number
G1 receiver	1	31210010
Power/data cable, 15 m (accessory item)*	1	31110053
Serial-to-NMEA 2000 adapter	1	31210011
ComNav Tool Kit CD	1	29030052
User Manual	1	29010087

Table 1-1: Parts list

***Note:** if G1 system Part number 11210029 was ordered, use cable part number 31110052 for serial adapter 31210011, rather than cable part number 31110053.

Chapter 2: Installation

Mounting Location

Mounting Orientation

Mounting Options

Powering the G1

Connecting the G1 to External Devices

Mounting Location

This section provides information on determining the best location for the G1.

Note: Mounting Template available -Vector G1 Satellite Compass part number 29030054

GPS Reception

When considering where to mount the G1, consider the following GPS reception recommendations:

- Consider GPS (and hence SBAS) reception, ensuring there is a clear view of the sky available to the G1 so the GPS and SBAS satellites are not masked by obstructions that may reduce system performance
- Since the G1 computes a position based on the internal primary GPS antenna element, mount the G1 where you desire a position with respect to the primary GPS antenna (located on the end opposite the recessed arrow on the underside of the enclosure)



- Locate any transmitting antennas away from the G1 by at least a several feet to ensure tracking performance is not compromised, giving you the best performance possible
- Make sure there is enough cable length to route into the vessel to reach a breakout box or terminal strip
- Do not locate the antenna where environmental conditions exceed those specified in Table B-5 on page 54

G1 Environmental Considerations

The G1 is designed to withstand harsh environmental conditions; however, adhere to the following limits when storing and using the G1:

- Operating temperature: -30°C to +70°C (-22°F to +158°F)
- Storage temperature: -40°C to +85°C (-40°F to +185°F)
- Humidity: 100% non-condensing

VHF Interference

VHF interference from such devices as cellular phones and radio transmitters may interfere with GPS operation. Keep the following in mind regarding VHF interference:

- VHF marine radio working frequency (Channel 1 to 28) is from 156.05 to 157.40 MHz. The L1 GPS working center frequency is 1575.42 MHz. The bandwidth is +/- 2MHz to +/- 10 MHz, which is dependent on the GPS antenna and receiver design.
- VHF marine radios emit strong harmonics. The 10th harmonic of VHF radio, in some channels, falls into the GPS working frequency band, which may cause the SNR of GPS to degrade significantly.
- The radiated harmonic signal strength of different brands/ models varies.

- Follow VHF radio manufacturers' recommendations on how to mount their radios and what devices to keep a safe distance away.
- Handheld 5W VHF radios may not provide suitable filtering.

Before installing the G1, use the following diagram to ensure there are no nearby devices that may cause VHF interference.

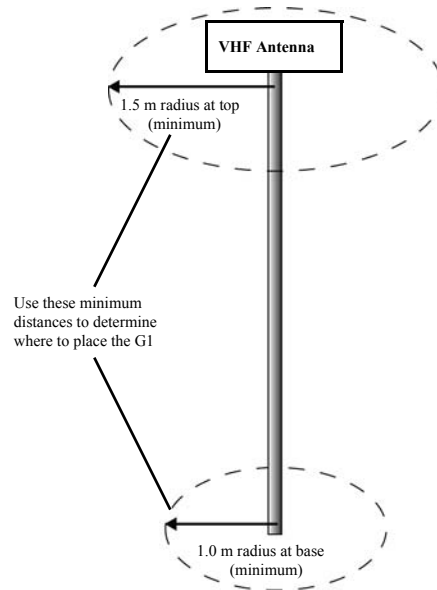

Figure 2-1: G1 distance from nearby VHF radios

Mounting Orientation

The G1 outputs heading, pitch, and roll readings regardless of the orientation of the antennas. However, the relation of the antennas to the boat's axis determines whether you will need to enter a heading, pitch, or roll bias. The primary antenna is used for positioning and the primary and secondary antennas, working in conjunction, output heading, pitch, and roll values.

Note: Regardless of which mounting orientation you use, the G1 provides the ability to output the heave of the vessel. This output is available via the \$GPHEV message.

Parallel Orientation: The most common installation is to orient the G1 parallel to, and along the centerline of, the axis of the boat. This provides a true heading. In this orientation:

- If you use a gyrocompass, you can enter a heading bias in the G1 to calibrate the physical heading to the true heading of the vessel.
- You may need to adjust the pitch/roll output to calibrate the measurement if the Vector is not installed in a horizontal plane.

Perpendicular Orientation: You can also install the antennas so they are oriented perpendicular to the centerline of the boat's axis. In this orientation:

- You will need to enter a heading bias of $+90^\circ$ if the primary antenna is on the starboard side of the boat and -90° if the primary antenna is on the port side of the boat.
- You will need to configure the receiver to specify the GPS antennas are measuring the roll axis using \$JATT,ROLL,YES.
- You will need to enter a roll bias to properly output the pitch and roll values.
- You may need to adjust the pitch/roll output to calibrate the measurement if the Vector is not installed in a horizontal plane.

Figure 2-2 and Figure 2-3 provide mounting orientation examples.

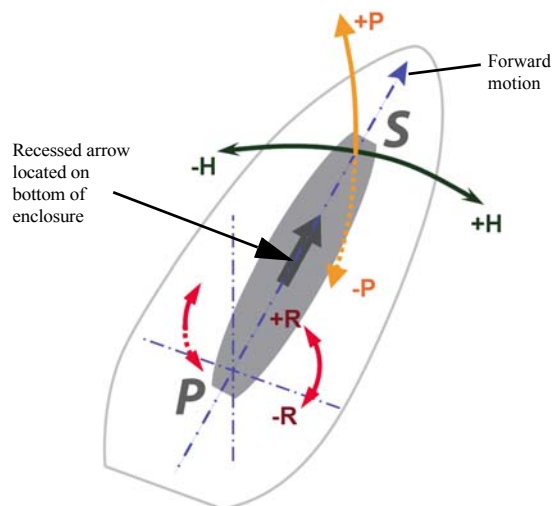

Figure 2-2: Recommended orientation and resulting signs of HPR values

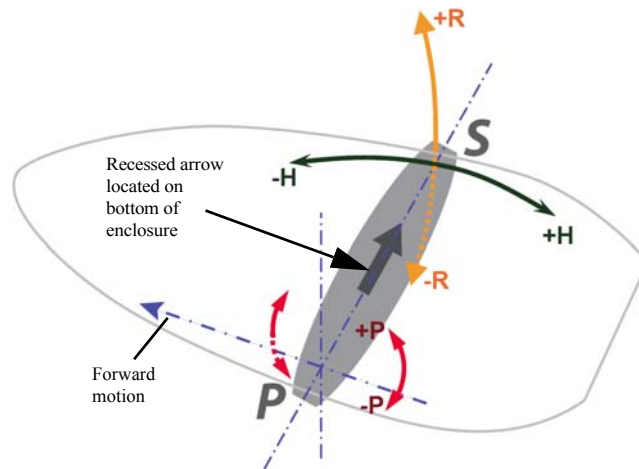

Figure 2-3: Alternate orientation and resulting signs of HPR values

G1 Alignment

The top of the G1 enclosure incorporates sight design features to help you align the enclosure with respect to an important feature on your vessel.

To use the sights, center the small post on the opposite side of the enclosure from you, within the channel made in the medallion located in the center of the enclosure top as shown in Figure 2-4 and Figure 2-5. Alignment accuracy when looking through the long site (Figure 2-4) is approximately $\pm 1^\circ$, while alignment through the short site (Figure 2-5) is approximately $\pm 2.5^\circ$.



Figure 2-4: Long site alignment

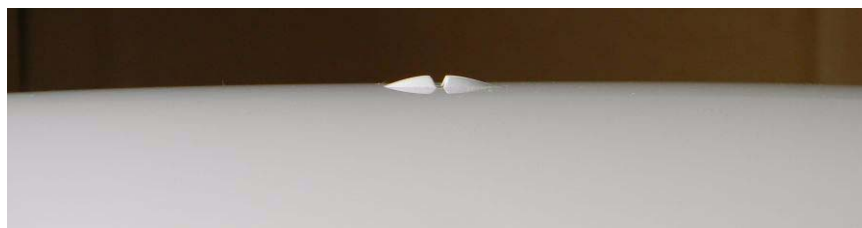

Figure 2-5: Short sight alignment

If you have another accurate source of heading data on your vessel, such as a gyrocompass, you may use its data to correct for a bias in G1 alignment within the G1 software configuration. Alternatively, you can physically adjust the heading of the G1 so that it renders the correct heading measurement; however, adding a software offset is an easier process.

Mounting Options

The G1 allows for two different mounting options: flush mount and pole mount.

- Flush mount - The bottom of the G1 contains four M8 holes for flush mounting the unit to a flat surface (see Figure 2-6).
- Pole mount - The bottom of the G1 contains a mounting hole (1" thread, 0.9" depth) for easy pole mounting. Hand tighten until snug (**do not** overtighten). The set screws on the long sides of the base (see diagram below) allow you to secure the G1 in place (3/16" Allen wrench not included).

G1 Dimensions

Figure 2-6 illustrates the physical dimensions of the G1.

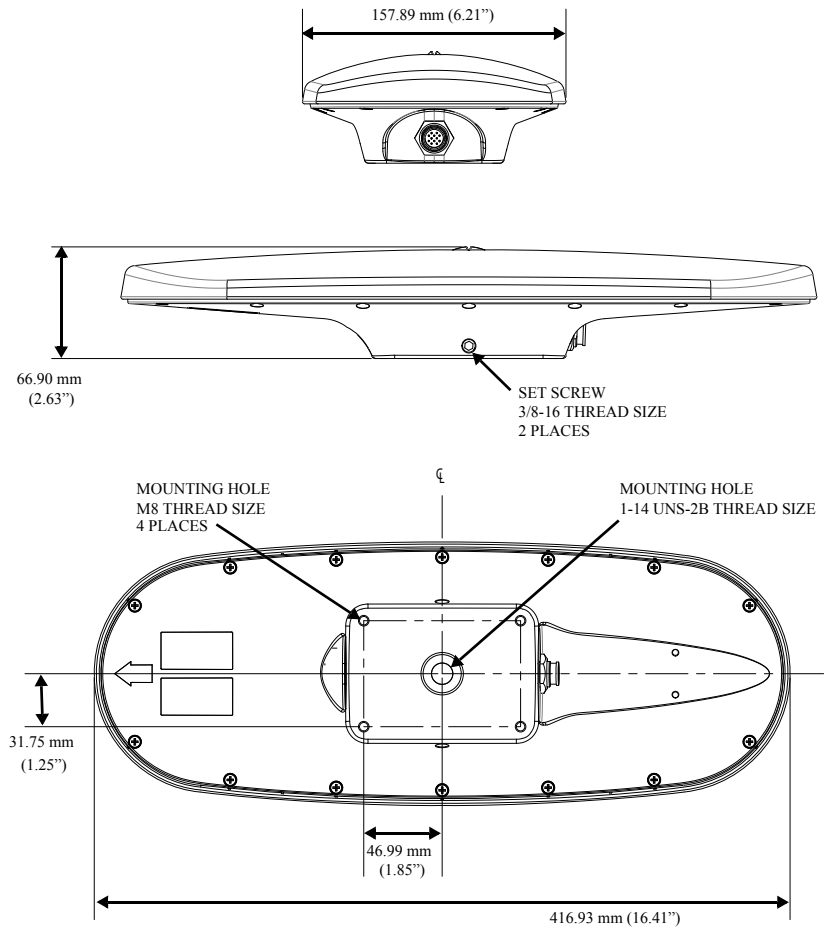

Figure 2-6: G1 dimensions

Power/Data Cable Considerations

Before mounting the G1 consider the following regarding power/data cable routing:

- Cable must reach an appropriate power source
- Cable may connect to a data storage device, computer, or other device that accepts GPS data
- Avoid running the cable in areas of excessive heat
- Keep cable away from corrosive chemicals
- Do not run the cable through door or window jams
- Keep cable away from rotating machinery
- Do not crimp or excessively bend the cable
- Avoid placing tension on the cable
- Remove unwanted slack from the cable at the G1 end
- Secure along the cable route using plastic wraps

⚠ WARNING: Improperly installed cable near machinery can be dangerous

Flush Mount

The bottom of the G1 contains four holes for flush mounting the unit to a flat surface (Figure 2-7). The flat surface may be something you fabricate per your installation, an off-the-shelf item (such as a radar mounting plate), or an existing surface on your vessel.

Note: ComNav does not supply the mounting surface hardware. You must supply the appropriate fastening hardware required to complete the installation of the G1.



Figure 2-7: Flush mounting holes on bottom of G1

Note: You do not necessarily need to orient the antenna precisely as you can enter a software offset to accommodate for any bias in heading measurement due to installation.

Before flush mounting the G1:

- Determine your mounting orientation. See “Mounting Orientation” on page 7 for more information.

- Choose a location that meets the mounting location requirements.
- Using the fixed base as a template, mark and drill the mounting holes as necessary for the mounting surface.

Flush mounting the G1:

1. Photocopy the section of the G1 that contains the four mounting holes for use as a template to plan the mounting hole locations.

▲WARNING: Make sure the photocopy is scaled one to one with the mounting holes on the bottom of the G1.

2. Mark the mounting hole centers on the mounting surface.
3. Place the G1 over the marks to ensure the planned hole centers align with the true hole centers (adjusting as necessary).
4. Use a center punch to mark the hole centers.
5. Drill the mounting holes with a 9 mm bit appropriate for the surface.
6. Place the G1 over the mounting holes and insert the mounting screws through the bottom of the mounting surface and into the G1.

▲WARNING: When installing the G1, hand tighten only. Damage resulting from overtightening is not covered by the warranty.

Pole Mount

Keep the following in mind when using a pole mount:

- Mounting hole is 1" thread, 0.9" depth
- Hand tighten until snug (do not overtighten) while ensuring correct orientation
- Use the set screws on the long sides of the base (see Figure 2-6) to secure the G1 in place (3/16" Allen wrench not included)

▲WARNING: Overtightening may damage the system. This is not covered under warranty.

Before pole mounting the G1:

- Decide if you need the roll measurement. If you need roll measurement, the G1 will need to be installed perpendicular to the vessel axis. If it you do not need roll measurement, install the G1 parallel with the vessel's axis.
- Choose a location that meets the mounting location requirements.

Connecting the power/data cable:

Note: This procedure is for connecting the serial 12-pin power/data cable to the G1. To connect the serial-to-NMEA 2000 adapter to the G1, connect in a similar manner. See “NMEA 2000 Port” on page 14 for more information on the adapter.

1. Align the cable connector keyway with the G1 connector key.

Make sure the connector keyway on the cable matches up with the connector key on the G1



Cable connector keyway



G1 connector key

2. Rotate the cable ring clockwise until it locks. The locking action is firm, but you will feel a positive “click” when it has locked.



Cable ring

Ports

The G1 offers either serial port or NMEA 2000 port functionality.

Serial Ports

The G1 offers position and heading data via two full-duplex (bi-directional) RS-232 serial ports. In addition to outputting data, these ports are used for firmware upgrades.

Selecting Baud Rates and Message Types

When selecting your baud rate and message types, use the following calculation to determine your baud rate for your required data throughput.

Messages * Message output rate * Message length (bytes) * bits in byte

Ex: 5 * 20Hz * 40 bytes * 10 = 40,000 bits/sec

Configuring the Ports

System PN 11210030 default as follows: PORT A set for NMEA 0183 @ 4800 Baud. PORT C set for NMEA 2000.

System PN 11210029 default as follows: PORT A set for NMEA 0183 @ 4800 Baud. PORT C set for NMEA 2000.

You may configure Port A or Port C of the GPS receiver to output any combination of data that you want. Port A can have a different configuration from Port C in terms of data message output, data rates, and the baud rate of the port. This allows you to configure the ports independently based upon your needs.

Port A is always a serial port. To configure Port C as a serial port refer to Table 2-1 on page 16.

If you want one generalized port and one heading-only port, you can configure the ports as follows:

- Port A to have GPGGA, GPVTG, GPGSV, GPZDA, and GPHDT all output at 1 Hz over a 9600 baud rate
- Port C to have GPHDT and GPROT output at their maximum rate of 20 Hz over a 19200 baud rate

A personal computer (PC) typically uses a DB9-male connector for RS-232 serial port communications.

Note: For successful communications use the 8-N-1 protocol and set the baud rate of the G1's serial ports to match that of the devices to which they are connected. Flow control is not supported.

Recommendations for Connecting to Other Devices

When interfacing to other devices, ensure the transmit data output from the G1 is connected to the data input of the other device. The signal grounds must also be connected.

The G1 input ports are designed to work with the Navigator G2 compass display or PC ComNav Toolkit for configuration purpose. There is likely little reason to connect the receive data input of the G1 to another device. Unused input line can be left open.

Detailed wiring diagram for connections to ComNav autopilots and GPS display units are given in Appendix D.

NMEA 2000 Port

By default, Port C is configured as a NMEA 2000 port with the default baud rate of 57600.

To use G1 for NMEA 2000 you have to connect the included serial-to-NMEA 2000 adapter (P/N 676-0026-000#) to the unit. Figure 2-8 shows the adapter. Insert the 12-pin connector of the adapter into the male end of the 12-pin connector on the G1 by aligning the keys. You can then attach the adapter to the unit using the supplied screws (machine, 8-32, 1/2", PPHC, SS) and washer (washer, flat, #8, SS). The 5-pin male Micro-C connector connects to your NMEA 2000 drop cable.

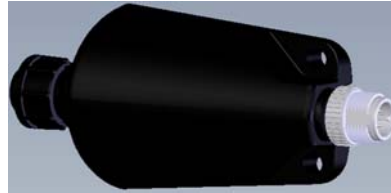
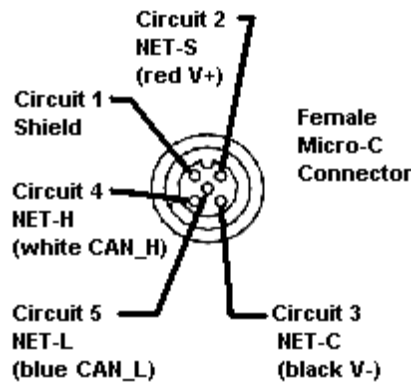

Figure 2-8: Serial-to-NMEA 2000 adapter



NMEA 2000 Standard pinout

Table 2-1 lists the commands used to configure Port C back to serial or NMEA 2000 when necessary. You can only send these commands using Port A.

Table 2-1: Commands for changing Port C (must be sent through Port A)

Command	Reply	Description
\$JRELAY,PORTC,\$JSERIALMODE	\$>JSERIALMODE,ENABLED \$>resetting	Switch Port C to serial
\$JRELAY,PORTC,\$JN2KMODE	\$>JN2KMODE,ENABLED \$>resetting	Switch Port C to NMEA 2000

Table 2-2 shows the requested PGNs with the G1 in NMEA 2000 mode.

Table 2-2: Received messages based on a request

PG No. (PGN)	Description	Level	Default Update Rate (msec)	Freq (Hz)
059392	ISO Acknowledgement Used to acknowledge the status of certain requests addressed to a specific ECU.	B	On Request	On Request

Table 2-2: Received messages based on a request (continued)

PG No. (PGN)	Description	Level	Default Update Rate (msec)	Freq (Hz)
059904	ISO Request Request the transmission of a specific PGN, addressed or broadcast.	B	On Request	On Request
060928	ISO Address Claim Used to identify to other ECUs the address claimed by an ECU.	B	On Request	On Request
126996	Product Information NMEA 2000 database version supported, manufacturer's product code, NMEA 2000 certification level, Load Equivalency number, and other product-specific information.	B	On Request	On Request
126464	Receive/Transmit PGNs group function The Transmit / Receive PGN List Group type of function is defined by first field. The message will be a Transmit or Receive PGN List group function.	B	On Request	On Request
129538	GNSS Control Status GNSS common satellite receiver parameter status.	B	On Request	On Request
129545	GNSS RAIM Output Used to provide the output from a GNSS receiver's Receiver Autonomous Integrity Monitoring (RAIM) process. The Integrity field value is based on the parameters set in PGN 129546 GNSS RAIM Settings.	B	On Request	On Request
129546	GNSS RAIM Settings Used to report the control parameters for a GNSS Receiver Autonomous Integrity Monitoring (RAIM) process.	B	On Request	On Request

Table 2-3 shows the transmitted PGNs with their default update rate with the G1 in NMEA 2000 mode.

Table 2-3: Transmitted messages

PG No. (PGN)	Description	Level	Default Update Rate (msec)	Freq (Hz)
126992	System Time The purpose of this PGN is twofold: To provide a regular transmission of UTC time and date. To provide synchronism for measurement data.	B	1000	1
127250	Vessel Heading Heading sensor value with a flag for True or Magnetic. If the sensor value is Magnetic, the deviation field can be used to produce a Magnetic heading, and the variation field can be used to correct the Magnetic heading to produce a True heading.	B	100	10

Table 2-3: Transmitted messages (continued)

PG No. (PGN)	Description	Level	Default Update Rate (msec)	Freq (Hz)
127251	Rate of Turn Rate of change of the Heading.	B	100	10
127257	Attitude Provides a single transmission that describes the position of a vessel relative to both horizontal and vertical planes. This would typically be used for vessel stabilization, vessel control and onboard platform stabilization.	B	1000	1
127258	Magnetic Variation Message for transmitting variation. The message contains a sequence number to allow synchronization of other messages such as Heading or Course over Ground. The quality of service and age of service are provided to enable recipients to determine an appropriate level of service if multiple transmissions exist.		1000	1
128259	Speed Provides a single transmission that describes the motion of a vessel.	B	1000	1
129025	Position, Rapid Update Provides latitude and longitude referenced to WGS84. Being defined as single frame message, as opposed to other PGNs that include latitude and longitude and are defined as fast or multi-packet, this PGN lends itself to being transmitted more frequently without using up excessive bandwidth on the bus for the benefit of receiving equipment that may require rapid position updates.	B	100	10
129026	COG & SOG, Rapid Update Single frame PGN that provides Course Over Ground (COG) and Speed Over Ground (SOG).	B	250	4
129027	Position Delta, High Precision Rapid Update The "Position Delta, High Precision Rapid Update" Parameter Group is intended for applications where very high precision and very fast update rates are needed for position data. This PGN can provide delta position changes down to 1 mm with a delta time period accurate to 5 msec.	B	100	10
129028	Altitude Delta, High Precision Rapid Update The "Altitude Delta, High Precision Rapid Update" Parameter Group is intended for applications where very high precision and very fast update rates are needed for altitude and course over ground data. This PG can provide delta altitude changes down to 1 millimeter, a change in direction as small as 0.0057°, and with a delta time period accurate to 5 msec.	B	100	10
129029	GNSS Position Data Conveys a comprehensive set of Global Navigation Satellite System (GNSS) parameters, including position information.	B	1000	1

Table 2-3: Transmitted messages (continued)

PG No. (PGN)	Description	Level	Default Update Rate (msec)	Freq (Hz)
129033	Time & Date Single transmission that provides UTC time, UTC Date, and Local Offset.	B	1000	1
129539	GNSS DOPs Provides a single transmission containing GNSS status and dilution of precision components (DOP) that indicate the contribution of satellite geometry to the overall positioning error. There are three DOP parameters reported: horizontal (HDOP), Vertical (VDOP), and time (TDOP).	B	1000	1
129540	GNSS Sats in View GNSS information on current satellites in view tagged by sequence ID. Information includes PRN, elevation, azimuth, SNR, defines the number of satellites; defines the satellite number and the information.	B	1000	1

Powering the G1

Power Considerations

For best performance use a clean and continuous power supply. The G1 power supply features reverse polarity protection but will not operate with reverse polarity.

See Table B-3 on page 53 for complete power specifications.

Connecting to a Power Source

Note: This section refers to powering the unit via serial connection. To power the unit via NMEA 2000 connection, following the standard procedure for powering up via NMEA 2000.

Before you power up the G1 you must terminate the wires of the power cable as required. There are a variety of power connectors and terminals on the market from which to choose, depending on your specific requirements.

⚠ WARNING: Do not apply a voltage higher than 36 VDC. This will damage the receiver and void the warranty.

To interface the G1 power cable to the power source:

- Connect the red wire of the cable's power input to DC positive (+)
- Connect the black wire of the cable's power input to DC negative (-)

The G1's smart antenna will start when an acceptable voltage is applied to the power leads of the extension cable.

Electrical Isolation

The G1's power supply is isolated from the communication lines and the PC-ABS plastic enclosure isolates the electronics mechanically from the vessel (addressing the issue of vessel hull electrolysis).

Connecting the G1 to External Devices

Note: This section refers to a serial connection. For connecting external NMEA 2000 devices, plug the serial-to-NMEA 2000 adapter into the G1 and then attach a standard NMEA 2000 dropline cable to the adapter.

Power/Data Cable Considerations

The G1 uses a single 15 m (49 ft) cable for power and data input/output.

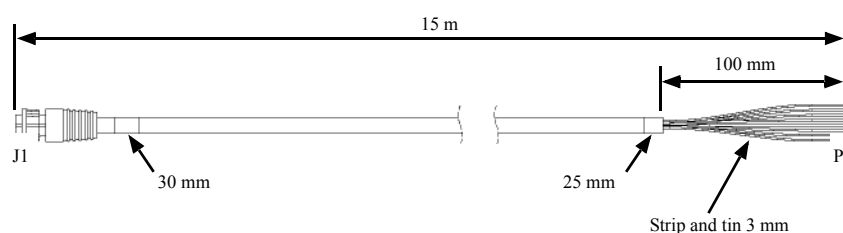

Figure 2-9: Power/data cable, 15 m

The receiver end of the cable is terminated with an environmentally sealed 12-pin connection while the opposite end is unterminated and requires field stripping and tinning.

Depending on the application and installation needs, you may need to shorten this cable. However, if you require a longer cable run than 15 m, you can bring the cable into a break-out box that incorporates terminal strips, within the vessel.

When lengthening the cable keep the following in mind:

- To lengthen the serial lines inside the vessel, use 20-gauge twisted pairs and minimize the additional wire length.
- When lengthening the power input leads to the G1, ensure the additional voltage drop is small enough that your power system can continue to power the system above the minimum voltage of the system. Wire of 18-gauge or larger should also be used.
- Length limits for RS-232 cables

Power/Data Cable Pinout Specifications

Figure 2-10 show the power/data cable plug pinout while Table 2-4 shows the cable’s pinout specifications.

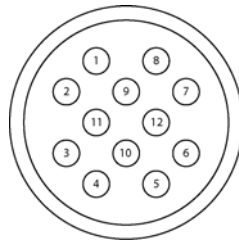

Figure 2-10: Power/data cable pin assignment

Table 2-4: Power/data cable pinout

Pin	Function	Wire Color
1	Port C, RS-232 female DB9 pin 2, device out (Tx)	White
2	Port C, RS-232 female DB9 pin 3, device in (Rx)	Green
3	N/C	N/C
4	N/C	N/C
5	Power input	Red
6	N/C	N/C
7	Signal ground	Yellow
8	Port A, RS-232 female DB9 pin 3, device in (Rx)	Brown
9	Port A, RS-232 female DB9 pin 2, device out (Tx)	Blue
10	Power ground	Black
11	CH_GND	Drain
12	N/C	N/C

Chapter 3: Operation

GPS Overview

Vector G1 Overview

Messages and Configuration Commands

GPS Overview

For your convenience, both the GPS and SBAS operation of the Vector G1 features automatic operational algorithms. When powered for the first time, the Vector G1 performs a "cold start," which involves acquiring the available GPS satellites in view and the SBAS differential service.

If SBAS is not available in your area, an external source of RTCM SC-104 differential corrections may be used. If you use an external source of correction data, it must support an eight data bit, no parity, one stop bit configuration (8-N-1).

GPS Operation

The GPS receiver is always operating, regardless of the DGPS mode of operation. The following sections describe the general operation of the G1's internal GPS receiver.

Note: Differential source and status have no impact on heading, pitch, or roll. They only have an impact on positioning.

Automatic Tracking

The G1's internal GPS receiver automatically searches for GPS satellites, acquires the signals, and manages the navigation information required for positioning and tracking.

Receiver Performance

The G1 works by finding four or more GPS satellites in the visible sky. It uses information from the satellites to compute a position within 4.0 m (8.2 ft). Since there is some error in the GPS data calculations, the G1 also tracks a differential correction. The G1 uses these corrections to improve its position accuracy to better than 1.0 m (1.97 ft).

There are two main aspects of GPS receiver performance:

- Satellite acquisition
- Positioning and heading calculation

When the G1 is properly positioned, the satellites transmit coded information to the antennas on a specific frequency. This allows the receiver to calculate a range to each satellite from both antennas. GPS is essentially a timing system. The ranges are calculated by timing how long it takes for the signal to reach the GPS antenna. The GPS receiver uses a complex algorithm incorporating satellite locations and ranges to each satellite to calculate the geographic location and heading. Reception of any four or more GPS signals allows the receiver to compute three-dimensional coordinates and a valid heading.

Differential Operation

The purpose of differential GPS (DGPS) is to remove the effects of selective availability (SA), atmospheric errors, timing errors, and satellite orbit errors, while enhancing system integrity. Autonomous positioning capabilities of the G1 will result in positioning accuracies of 4.0 m (8.2 ft) 95% of the time. In order to improve positioning quality to better than 1.0 m (1.97 ft), the G1 is able to use differential corrections received through the internal SBAS demodulator or externally-supplied RTCM corrections.

Automatic SBAS Tracking

The G1 automatically scans and tracks SBAS signals without the need to tune the receiver. The G1 features two-channel tracking that provides an enhanced ability to maintain a lock on an SBAS satellite when more than one satellite is in view. This redundant tracking approach results in more consistent tracking of an SBAS signal in areas where signal blockage of a satellite is possible.

Vector G1 Overview

The G1 provides accurate and reliable heading and position information at high update rates. To accomplish this task, the G1 uses a high performance GPS receiver and two antennas for GPS signal processing. One antenna is designated as the primary GPS antenna and the other is the secondary GPS antenna. Positions computed by the G1 are referenced to the phase center of the primary GPS antenna. Heading data references the vector formed from the primary GPS antenna phase center to the secondary GPS antenna phase center.

The heading arrow located on the bottom of the G1 enclosure defines system orientation. The arrow points in the direction the heading measurement is computed (when the antenna is installed parallel to the fore-aft line of the vessel). The secondary antenna is directly above the arrow.

Fixed Baseline Moving Base Station RTK

The G1's internal GPS receiver uses both the L1 GPS C/A code and carrier phase data to compute the location of the secondary GPS antenna in relation to the primary GPS antenna with a very high sub-centimeter level of precision. The technique of computing the location of the secondary GPS antenna with respect to the primary antenna, when the primary antenna is moving, is often referred to as moving base station Real Time Kinematic (or moving base station RTK).

Generally, RTK technology is very sophisticated and requires a significant number of possible solutions to be analyzed where various combinations of integer numbers of L1 wavelengths to each satellite intersect within a certain search volume. The integer number of wavelengths is often referred to as the "ambiguity" as they are initially ambiguous at the start of the RTK solution.

The G1 restricts the RTK solution. It does this knowing that the secondary GPS antenna is 0.27 m (0.89 ft) from the primary GPS antenna. This is called a fixed baseline and it defines the search volume of the secondary antenna as the surface of a sphere with radius 0.27 m (0.89 ft) centered on the location of the primary antenna (see Figure 3-1).

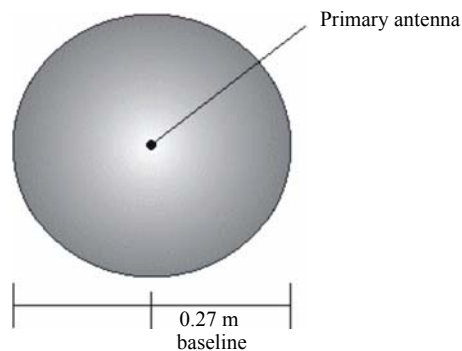

Figure 3-1: Secondary antenna's search volume

Note: The Vector G1 moving base station algorithm only uses GPS to calculate heading. Differential corrections are not used in this calculation and will not affect heading accuracy.

Supplemental Sensors

The G1 has an integrated gyro and two tilt sensors. The gyro and tilt sensors are enabled by default. Each supplemental sensor may be individually enabled or disabled. Both supplemental sensors are mounted on the printed circuit board inside the G1.

The sensors act to reduce the RTK search volume, which improves heading startup and reacquisition times. This improves the reliability and accuracy of selecting the correct heading solution by eliminating other possible, erroneous solutions. Table 3-1 on page 24 provides a sensor operation summary.

Feature	Normal Operation	Coasting (no GPS)
Heading	GPS	Gyro
Heave	GPS	None
Pitch	GPS	Inertial sensor
Roll	Inertial sensor	Inertial sensor

Table 3-1: Sensor operation summary

Sensors can be recalibrated, queried, or disabled by some NMEA-like sentences. See descriptions in Messages and Configuration Commands.

Tilt Aiding

The G1's accelerometers (internal tilt sensors) are factory calibrated and enabled by default. This constrains the RTK heading solution beyond the volume associated with just a fixed antenna separation. This is because the G1 knows the approximate inclination of the secondary antenna with respect to the primary antenna. The search space defined by the tilt sensor will be reduced to a horizontal ring on the sphere's surface by reducing the search volume. This considerably decreases startup and reacquisition times. (See Figure 3-2)

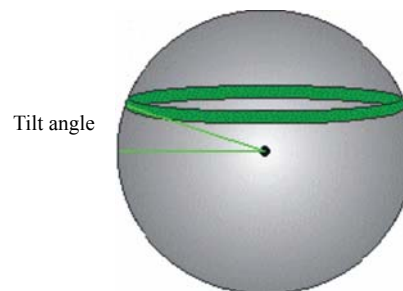

Figure 3-2: Vector G1's tilt aiding

Gyro Aiding

The G1's internal gyro offers several benefits. It reduces the sensor volume for an RTK solution. This shortens reacquisition times when a GPS heading is lost because the satellite signals were blocked. The gyro provides a relative change in angle since the last computed heading, and, when used in conjunction with the tilt sensor, defines the search space as a wedge-shaped location. (See Figure 3-3)

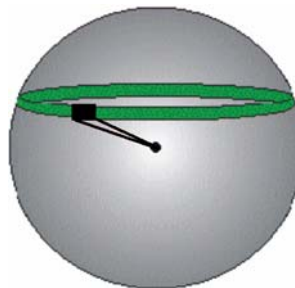

Figure 3-3: Vector G1's gyro aiding

The gyro aiding accurately smoothes the heading output and the rate of turn. It provides an accurate substitute heading for a short period depending on the roll and pitch of the vessel, ideally seeing the system through to reacquisition. The gyro provides an alternate source of heading, accurate to within 1° for up to three minutes, in times of GPS loss for either antenna. If the outage lasts longer than three minutes, the gyro

will have drifted too far and the G1 begins outputting null fields in the heading output messages. There is no user control over the timeout period of the gyro.

Calibration, which is set at the factory, is required for the gyro to remove latency from the heading solution as well as provide backup heading when GPS is blocked. The receiver will calibrate itself after running for a while but it may be important to follow the manual calibration instructions if you want to guarantee performance quickly after powering up the receiver.

The gyro initializes itself at powerup and during initialization, or you can calibrate it using \$JATT. When the gyro is first initializing, it is important that the dynamics that the gyro experiences during this warmup period are similar to the regular operating dynamics. For example, if you use the G1 on a high speed, maneuverable craft, it is essential that when gyro aiding in the G1 is first turned on, use it in an environment that has high dynamics for the first five to ten minutes instead of sitting stationary.

With the gyro enabled, the gyro is also used to update the post HTAU smoothed heading output from the moving base station RTK GPS heading computation. This means that if the HTAU value is increased while gyro aiding is enabled, there will be little to no lag in heading output due to vehicle maneuvers. Setting an appropriate HTAU value for the application is further discussion later.

Time Constants

The G1 incorporates user-configurable time constants that can provide a degree of smoothing to the heading, course over ground (COG), and speed measurements. You can adjust these parameters depending on the expected dynamics of the vessel. For example, increasing the time is reasonable if the vessel is very large and is not able to turn quickly or would not pitch quickly. The resulting values would have reduced “noise,” resulting in consistent values with time. However, if the vessel is quick and nimble, increasing this value can create a lag in measurements. If you are unsure on how to set this value, it is best to be conservative and leave it at the default setting.

Note: There is no lag once the gyro is calibrated and enabled.

Heading time constant: Use the \$JATT,HTAU command to adjust the level of responsiveness of the true heading measurement provided in the \$GPHDT message. The default value of this constant is 2.0 seconds of smoothing when the gyro is enabled. The gyro is enabled by default, but can be turned off. By turning the gyro off, the equivalent default value of the heading time constant would be 0.5 seconds of smoothing. This is not automatically done and therefore you must manually enter it. Increasing the time constant increases the level of heading smoothing and increases lag. You can use the following formula to determine level of heading smoothing required when the gyro is in use:

$htau$ (in seconds) = 40 / maximum rate of turn (in /sec).

When the gyro is disabled, the formula is: $htau$ (in seconds) = 10 / maximum rate of turn (in /sec)

Pitch time constant: Use the \$JATT,PTAU command to adjust the level of responsiveness of the pitch measurement provided in the \$PSAT,HPR message. The default value of this constant is 0.5 seconds of smoothing. Increasing the time constant increases the level of pitch smoothing and increases lag. you can use the following formula to determine the level of pitch smoothing required: $ptau$ (in seconds) = 10 / maximum rate of pitch (in /sec)

Heading Rate time constant: Use the \$JATT,HRTAU command to adjust the level of responsiveness of the rate of heading change measurement provided in the \$GPROT message. The default value of this constant is 2.0 seconds of smoothing. Increasing the time constant increases the level of heading smoothing. You can use the following formula to determine the level of smoothing: $hrtau$ (in seconds) = 10 / maximum rate of the rate of turn (in /sec).

Course Over Ground (COG) time constant: Use the \$JATT,COGTAU command to adjust the level of responsiveness of the COG measurement provided in the \$GPVTG message. The default value of this constant is 0.0 seconds of smoothing. Increasing the time constant increases the level of COG smoothing. COG is computed using only the primary GPS antenna and its accuracy depends upon the speed of the vessel (noise is proportional to 1/speed). This value is invalid when the vessel is stationary, as tiny movements due to calculation inaccuracies are not representative of a vessel's movement. You can use the following formula to determine COGTAU: $\text{cogtau (in seconds)} = 10 / \text{maximum rate of change of course (in degree/sec)}$.

Speed time constant: Use the \$JATT,SPDTAU command to adjust the level of responsiveness of the speed measurement provided in the \$GPVTG message. The default value of this constant is 0.0 seconds of smoothing. Increasing the time constant increases the level of speed measurement smoothing.

Watchdog

The watchdog is a timer that is controlled by the software that monitors if the heading is lost. The watchdog software is compliant with IEC 60495.

Messages and Configuration Commands

Table 3-2: Commands

Command	Description
\$JAGE	Specify maximum DGPS (COAST) correction age (6 to 8100 seconds)
\$JAPP	Query or specify receiver application firmware
\$JASC	Specify ASCII messages to output to specific ports (see ASCII messages in Table 3-3)
\$JBAUD	Specify RS-232 (output) communication rate
\$JBIN	Specify binary messages to output to specific ports (see Table 3-4)
\$JDIFF	Query or specify differential correction mode
\$JGEO	Query or specify SBAS for current location and SBAS satellites
\$JI	Query unit's serial number and firmware versions
\$JOFF	Turn off all data messages
\$JQUERY,GUIDE	Query accuracy suitability for navigation
\$JRESET	Reset unit's configuration to firmware defaults Note: \$JRESET clears all parameters. For the G1 you will have to issue the \$JATT, FLIPBRD, YES command to properly redefine the circuitry orientation inside the product once the receiver has reset. Failure to do so will cause radical heading behavior.
\$JSAVE	Save session's configuration changes

NMEA Output

The following NMEA 0183 & proprietary data output messages are the ones most commonly used on the Vector G1 (for others, see the next 3 pages). Factory enabled messages are shown in Grey, and the default repeat rate is shown in the default column. Factory disabled sentences are shown with an X. Once the Vector G1 is installed and setup correctly, record in the User column any changes you made for future reference.

In Table 3-3 the Info Type value is one of the following:

- P = Position
- V = Velocity, Time
- H = Heading, Attitude
- S = Sats, Stats, Quality

Table 3-3: NMEA 0183 and other messages

Message	Info Type	Description	IEC Approved Message	Enabled				Max Rate
				Port A		Port C		
				Default	User	Default	User	
\$GPDTM	P	Datum reference	Yes	X		X		1
\$GPGGA	P	GPS position and fix data	Yes	X		X		20**
\$GPGLL	P	Geographic position - lat/long	Yes	1		X		20**
\$GPGNS	P	GNSS position and fix data	Yes	X		X		20**
\$GPGRS	S	GNSS range residual (RAIM)	Yes	X		X		20**
\$GPGSA	S	GNSS DOP and active satellites	Yes	X		X		1

Table 3-3: NMEA 0183 and other messages (*continued*)

Message	Info Type	Description	IEC Approved Message	Enabled				Max Rate
				Port A		Port C		
				Default	User	Default	User	
\$GPGST	S	GNSS pseudo range error statistics and position accuracy	Yes	X		X		1
\$GPGSV	S	GNSS satellites in view	Yes	X		X		1
*\$GPHDG	H	Provides magnetic deviation and variation for calculating magnetic or true heading	Yes	X		X		20**
*\$GPHDM	H	Magnetic heading (based on GPS-derived heading and magnetic declination)	No	1		10		20**
*\$GPHDT	H	GPS-derived true heading	Yes	1		10		20**
\$GPHEV	H	Heave value (in meters)	Yes	X		X		20**
\$GPRMC	P	Recommended minimum specific GNSS data	Yes	X		X		20**
*\$GPROT	H	GPS-derived rate of turn (ROT)	Yes	1		X		20**
\$GPRRE	S	Range residual and estimated position error message	Yes	X		X		1
\$GPVTG	V	COG and ground speed	Yes	1		1		20**
\$GPZDA	V	Time and date	Yes	1		X		20**
\$PASHR	H	Time, heading, roll, and pitch data in one message	No					1
\$PSAT, GBS	S	Satellite fault detection (RAIM)	Yes					1
\$PSAT, HPR	H	Proprietary NMEA message that provides heading, pitch, roll, and time in single message	No	X		X		20**
\$PSAT, INTLT	H	Proprietary NMEA message that provides the pitch and roll measurements from the internal inclinometers (in degrees)	Yes	X		X		1
\$RDI	S	SBAS diagnostic information	Yes	X		X		1
\$TSS1	H	Heading, pitch, roll, and heave message in the commonly used TSS1 message format	No	X		X		20**
Notes: <ul style="list-style-type: none"> The GP of the message is the talker ID. GPGRS, GPGSA, GPGST and GPGSV support external integrity checking. They are to be synchronized with corresponding fix data (GPGGA or GPGNS). *You can change the message header for the HDG, HDM, HDT and ROT messages to either GP or HE using the \$JATT,NMEAHE command. ** Optional maximum rate. Fees may apply. 								

Table 3-4: Binary messages

\$JBIN Message	Description
1	GPS position
2	GPS DOPs
80	SBAS
93	SBAS ephemeris data
94	Ionosphere and UTC conversion parameters

Table 3-4: Binary messages (continued)

\$JBIN Message	Description
95	Satellite ephemeris data
96	Code and carrier phase
97	Processor statistics
98	Satellites and almanac
99	GPS diagnostics

Table 3-5: Parameters specific to \$JATT command

Parameter	Description	Query	Specify	Default
COGTAU	Set/query COG time constant (0.0 to 3600.0 sec)	X	X	0.00
CSEP	Query antenna separation	X		X
EXACT	Enable/disable internal filter reliance on the entered antenna separation	X	X	X
FLIPBRD	Turn the flip feature on/off	X	X	YES
GYROAID	Enable/disable gyro	X	X	YES
HBIAS	Set/query heading bias (-180.0° to 180.0°)	X	X	0.00
HELP	Show the available commands for GPS heading operation and status	X		X
HIGHMP	Set/query the high multipath setting for use in poor GPS environments	X	X	X
HRTAU	Set/query time constant (0.0 to 3600.0 sec)	X	X	2.00
HTAU	Set/query heading time constant (0.0 to 3600.0 sec)	X	X	10.00
LEVEL	Enable/disable level operation	X	X	NO
MSEP	Manually set or query antenna separation	X	X	X
NEGILT	Enable/disable negative tilt	X	X	NO
NMEAHE	Change the HDG, HDM, HDT, and ROT message headers between GP and HE	X	X	NO
PBIAS	Set/query pitch/roll bias (-15.0° to 15.0°)	X	X	0.00
PTAU	Set/query pitch time constant (0.0 to 3600.0 sec)	X	X	0.50
ROLL	Configure for roll or pitch GPS orientation	X	X	NO
SEARCH	Force a new GPS heading search		X	X
SPDTAU	Set/query speed time constant (0.0 to 3600.0 sec)	X	X	0.00
SUMMARY	Display a summary of the current Crescent Vector settings	X		X
TILTAID	Enable/disable accelerometer, pre-calibrated	X	X	YES
TILTCAL	Calibrate accelerometers		X	X

NMEA Configuration commands

The following NMEA-like input sentences can be used to configure the Vector G1.

To query what is the current value of most parameters, leave off the last ",value" portion of the sentence.

For those sentences that enable the output of repeating NMEA data sentences, the range of valid repeat rates is shown in parentheses; "0" causes the sentence to be disabled. Some sentences may only be disabled or enabled - with a NO or YES parameter value.

The optional parameter PORTX (without the square brackets), where applicable, causes the configuration parameter to be applied to the other port these sentences are NOT sent from. For example, if you send this command from Port A to configure Port C, you should add "PORTC" to the command; if you send this command from Port C to configure Port A, you should add PORTA.

Caution! These commands will affect the performance of the Vector G1. Improper settings may result in degradation of system output that can affect the overall safety of vessels and personnel.

Table 3-6: NMEA Configuration Sentences

Command	Description
\$JAGE,age[,PORTX]	Set Differential Age Timeout (6 to 8100 seconds)
\$JASC,D1,rate[,PORTX]	Output SBAS diagnostic information (rate = 0 or 1 Hz)
\$JASC,GPDTM,rate[,PORTX]	Output Datum Reference information (rate = 0 or 1 Hz)
\$JASC,GPGGA,rate[,PORTX]	Output GPS Fix data (rate = 0, 0.2, 1, 5, 10 or 20 Hz)
\$JASC,GPGLL,rate[,PORTX]	Output Geographic position (rate = 0, 0.2, 1, 5, 10 or 20 Hz)
\$JASC,GPGNS,rate[,PORTX]	Output GNSS Fix data (rate = 0, 0.2, 1, 5, 10 or 20 Hz)
\$JASC,GPGRS,rate[,PORTX]	Output GNSS Range Residual data (rate = 0, 0.2, 1, 5, 10 or 20 Hz)
\$JASC,GPGSA,rate[,PORTX]	Output GNSS DOP and Active Satellites (rate = 0 or 1 Hz)
\$JASC,GPGST,rate[,PORTX]	Output Pseudorange Error Statistics (rate = 0 or 1 Hz)
\$JASC,GPGSV,rate[,PORTX]	Output Satellites in View (rate = 0 or 1 Hz)
\$JASC,GPHDG,rate[,PORTX]	Output Generic Heading (rate = 0, 0.2, 1, 5, 10 or 20 Hz)
\$JASC,GPHDM,rate[,PORTX]	Output Magnetic Heading (rate = 0, 0.2, 1, 5, 10 or 20 Hz)
\$JASC,GPHDT,rate[,PORTX]	Output True Heading (rate = 0, 0.2, 1, 5, 10 or 20 Hz)
\$JASC,GPROT,rate[,PORTX]	Output Rate Of Turn (rate = 0, 0.2, 1, 5, 10 or 20 Hz)
\$JASC,GPRMC,rate[,PORTX]	Output Recommended Minimum Specific GNSS data (rate = 0, 0.2, 1, 5, 10 or 20 Hz)
\$JASC,GPRRE,rate[,PORTX]	Output Range Residual Error data (rate = 0 or 1 Hz)
\$JASC,GPVTG,rate[,PORTX]	Output Course Over Ground and Speed Over Ground data (rate = 0, 0.2, 1, 5, 10 or 20 Hz)
\$JASC,GPZDA,rate[,PORTX]	Output Time and Date (rate = 0, 0.2, 1, 5, 10 or 20 Hz)

Table 3-6: NMEA Configuration Sentences

Command	Description
\$JASC,PASHR,rate[,PORTX]	Output time, heading, roll, and pitch data in one message (rate = 0 or 1 Hz)
\$JASC,GPHPR,rate[,PORTX]	Output heading and pitch (or roll) data (rate = 0, 0.2, 1, 5, 10 or 20 Hz)
\$JASC,INTLT,rate[,PORTX]	Output Internal Tilt sensor measurement (rate = 0 or 1 Hz)
\$JASC,GPGBS,rate[,PORTX]	Output Receiver Autonomous Integrity Monitoring (RAIM) (rate = 0 or 1 Hz)
\$JASC,PTSS1,rate[,PORTX]	Output Heading, pitch, roll, and heave in TSS1 message format (rate = 0, 0.2, 1, 5, 10 or 20 Hz)
\$JATT,COGTAU,cogtau	Query or Set Course Smoothing Time (cogtau = 0.0 to 3600.0 seconds)
\$JATT,CSEP	Query Current Antenna Separation
\$JATT,EXACT,NO/YES	Query or Disable/enable the internal filter reliance on the entered antenna separation
\$JATT,FLIPBRD,NO/YES	Query the current flip feature status or turn off/on it. When the flip feature is turned off, the board is installed right side up (default mode).
\$JATT,GYROAID,NO/YES	Query or Disable/Enable the Gyro-Aid function
\$JATT,HBIAS,hbias	Query or Set Heading Output Offset (range is -180° to +180°) *
\$JATT,HELP	Provide a short list of commands available
\$JATT,HIGHMP,NO/YES	Query or Disable/enable the high multipath setting for use in poor GPS environment
\$JATT,HRTAU,hrtau	Query or Set Rate of Turn Smoothing Time (hrtau = 0.0 to 3600.0 seconds)
\$JATT,HTAU,htau	Query or Set Heading Smoothing Time (htau = 0.0 to 3600.0 seconds)
\$JATT,LEVEL,NO/YES	Query or Disable/Enable Level Mode Operation
\$JATT,MSEP,sep	Manually set antenna separation (this cannot be changed on the Vector G1)
\$JATT,NEGILT,NO/YES	Query or Set Normal/Reverse Pitch/Roll sign convention
\$JATT,NMEAHE,0	Set Talker ID for HDG, HDM & HDT sentences to GP
\$JATT,NMEAHE,1	Set Talker ID for HDG & HDT sentences to HE, and HDM to HC
\$JATT,PBIAS,pbias	Query or Set Pitch/Roll Bias (range is -15° to +15°)
\$JATT,PTAU,ptau	Query or Set Pitch Smoothing Time (ptau = 0.0 to 3600.0 seconds)
\$JATT,ROLL,NO/YES	Query or Set Pitch/Roll function to measure Pitch or Roll *
\$JATT,SEARCH	Force a new RTK Search
\$JATT,SPDTAU,spdtau	Query or Set Speed Smoothing Time Constant (spdtau = 0.0 to 200.0 seconds)
\$JATT,SUMMARY	Query Current Settings
\$JATT,TILTAID,NO/YES	Query or Disable/Enable the Tilt-Aid function

Table 3-6: NMEA Configuration Sentences

Command	Description
\$JATT,TILTCAL	Calibrate the Tilt-Aid sensor (the Vector G1 must be level, and all satellite signals be blocked, when this command is issued)
\$JBAUD,4800[,PORTX]	Set Baud rate to 4800
\$JBAUD,9600[,PORTX]	Set Baud rate to 9600
\$JBAUD,19200[,PORTX]	Set Baud rate to 19200
\$JBAUD,38400[,PORTX]	Set Baud rate to 38400
\$JBIN,1,rate	Output Binary GPS Position (rate = 0, 0.2, 1, 5, 10 or 20 Hz)
\$JBIN,2,rate	Output Binary GPS DOPs (rate = 0 or 1 Hz)
\$JBIN,80,rate	Output Binary GPS SBAS information (rate = 0 or 1 Hz)
\$JBIN,93,rate	Output Binary SBA ephemeris data (rate = 0 or 1 Hz)
\$JBIN,94,rate	Output Ionosphere & UTC conversion parameters (rate = 0 or 1 Hz)
\$JBIN,95,rate	Output Binary GPS ephemeris information (rate = 0 or 1 Hz)
\$JBIN,96,rate	Output Binary code & carrier phase information (rate = 0, 0.2, 1, 5, 10 or 20 Hz)
\$JBIN,97,rate	Output Binary process statistics (rate = 0, 0.2, 1, 5, 10 or 20 Hz)
\$JBIN,98,rate	Output Binary GPS Satellite & Almanac information (rate = 0 or 1 Hz)
\$JBIN,99,rate	Output Binary GPS diagnostic information (rate = 0 or 1 Hz)
\$JDIFF,NONE	Operate in autonomous mode
\$JDIFF,PORTX[,SAVE]	Use corrections input through PORT C or PORT A. Save the configuration if 'SAVE' is appended to the command
\$JDIFF,WAAS[,SAVE]	Use SBAS corrections; save the configuration if 'SAVE' is appended to the command
\$JGEO	Queries frequency and location of SBAS satellites
\$JI	Query the G1's serial number & firmware revisions
\$JOFF	Turn off all data output
\$JQUERY,GUIDE	Query whether the Vector G1 is providing suitable performance or not
\$JRESET	Reset to default settings** <u>DO NOT USE!!</u>
\$JSAVE	Save current Configuration wait until the Vector replies with "\$> Save Complete" before powering it down!
\$JSHOW	Show current Configuration
\$JSMOOTH,time	Query or Set Carrier Smoothing Time time = SHORT ==> 300 seconds time = LONG ==> 900 seconds time = 15 to 6000 seconds
\$JWAASPRN	Query PRNs of SBAS satellites currently being used

- * *Use the \$JATT,HBIAS & \$JATT,ROLL commands if the Vector is installed athwartships:*

\$JATT,ROLL,YES

and then (if you have mounted the Vector pointing to Port)

\$JATT,HBIAS,90.0

or (if you have mounted the Vector pointing to Starboard)

\$JATT,HBIAS,-90.0

- ** *This command sets the configuration parameters to the ComNav factory default values.*

Appendix A: Troubleshooting

Table A-1 provides troubleshooting for common problems.

Table A-1: Troubleshooting

Symptom	Possible Solution
Receiver fails to power	<ul style="list-style-type: none"> • Verify polarity of power leads • Check integrity of power cable connectors • Check power input voltage (6 to 36 VDC) • Check current restrictions imposed by power source (minimum available should be > 1.0 A)
No data from G1	<ul style="list-style-type: none"> • Check receiver power status to ensure the receiver is powered (an ammeter can be used for this) • Verify desired messages are activated (using ComNav Toolkit or \$JSHOW in any terminal program) • Ensure the baud rate of the G1 matches that of the receiving device • Check integrity and connectivity of power and data cable connections
Random data from G1	<ul style="list-style-type: none"> • Verify the RTCM or binary messages are not being output accidentally (send a \$JSHOW command) • Ensure the baud rate of the G1 matches that of the remote device • Potentially, the volume of data requested to be output by the G1 could be higher than the current baud rate supports (try using 19200 as the baud rate for all devices or reduce the amount of data being output)
No GPS lock	<ul style="list-style-type: none"> • Verify the G1 has a clear view of the sky • Verify the lock status of GPS satellites (this can be done with ComNav Toolkit)

Table A-1: Troubleshooting (continued)

Symptom	Possible Solution
No SBAS lock	<ul style="list-style-type: none"> • Verify the G1 has a clear view of the sky • Verify the lock status of SBAS satellites (this can be done with ComNav Toolkit - monitor BER value) • SBAS lock can only get if you are in an appropriate SBAS region (currently, there is limited SBAS availability in the southern hemisphere) • Set SBAS mode to automatic with the \$JWAASPRN,AUTO command
No heading or incorrect heading value	<ul style="list-style-type: none"> • Check CSEP value is fairly constant without varying more than 1 cm (0.39 in)—larger variations may indicate a high multipath environment and require moving the receiver location • Recalibrate the tilt sensor with \$JATT,TILTCAL command if heading is calculated then lost at consistent time intervals • Heading is from primary GPS antenna to secondary GPS antenna, so the arrow on the underside of the G1 should be directed to the bow side • \$JATT,SEARCH command forces the G1 to acquire a new heading solution (unless gyro is enabled) • Enable GYROAID to provide heading for up to three minutes during GPS signal loss • Enable TILTAID to reduce heading search times • Monitor the number of satellites and SNR values for both antennas within ComNav Toolkit—at least four satellites should have strong SNR values • Potentially, the volume of data requested to be output by the G1 could be higher than the current baud rate supports (try using 19200 as the baud rate for all devices or reduce the amount of data being output)
No DGPS position in external RTCM mode	<ul style="list-style-type: none"> • Verify the baud rate of the RTCM input port matches the baud rate of the external source • Verify the pinout between the RTCM source and the RTCM input port (transmit from the source must go to receive of the RTCM input port and grounds must be connected) • Ensure corrections are being transmitted to the correct port—using the \$JDIFF,PORTC command on Port A will cause the receiver to expect the corrections to be input through Port C

Appendix B: Specifications

Table B-1 through Table B-5 provide the G1’s GPS sensor, communication, power, mechanical, and environmental specifications.

Table B-1: GPS sensor specifications

Item	Specification
Receiver type	L1, C/A code with carrier phase smoothing
Channels	Two 12-channel, parallel tracking (Two 10-channel when tracking SBAS)
SBAS tracking	2-channel, parallel tracking
Update rate	Standard 10 Hz, optional 20 Hz (position and heading)
Horizontal accuracy	< 1.0 m 95% confidence (DGPS ¹) < 4.0 m 95% confidence (autonomous, no SA ²)
Heading accuracy	< 0.75° rms Normal operation: GPS Coasting (no GPS): Gyro
Heave accuracy	< 30 cm rms ⁵ Normal operation: GPS Coasting (no GPS): None
Pitch accuracy	< 1.5° rms Normal operation: GPS Coasting (no GPS): Inertial sensor
Roll accuracy	< 1.5° rms using accelerometer Normal operation: Inertial sensor Coasting (no GPS): Inertial sensor
Rate of turn	90°/s maximum
Cold start	< 60 s typical (no almanac or RTC)
Warm start	< 20 s typical (almanac and RTC)
Hot start	< 1 s typical (almanac, RTC, and position)
Heading fix	< 10 s typical (valid position)
Compass safe distance	30 cm (11.8 in) ⁴
Maximum speed	1,850 kph (999 kts)
Maximum altitude	18,288 m (60,000 ft)

Table B-2: Communication specifications

Item	Specification
Serial ports	2 full-duplex RS-232
Baud rates	4800, 9600, 19200, 38400, 57600, 115200
Correction I/O protocol	RTCM SC-104
Data I/O protocol	NMEA 0183, NMEA 2000

Table B-3: Power specifications

Item	Specification
Input voltage	6 to 36 VDC
Power consumption	~ 3 W nominal
Current consumption	320 mA @ 9 VDC 240 mA @ 12 VDC 180 mA @ 16 VDC
Power isolation	Isolated to enclosure
Reverse polarity protection	Yes

Table B-4: Mechanical specifications

Item	Specification
Enclosure	UV resistant, white plastic, AES HW 600G, non-corrosive, self extinguishing
Dimensions (not including mounts)	41.7 L x 15.8 W x 6.9 H (cm) 16.4 L x 6.2 W x 2.7 H (in)
Weight	~ 1.50 kg (3.3 lb)

Table B-5: Environmental specifications

Item	Specification
Operating temperature	-30°C to +70°C (-22°F to +158°F)
Storage temperature	-40°C to +85°C (-40°F to +185°F)
Humidity	100% non-condensing
Vibration	IEC 60945
EMC	FCC Part 15, Subpart B; CISPR22; IEC 60945 (CE)

¹Depends on multipath environment, number of satellites in view, satellite geometry, ionospheric activity, and use of SBAS

²Depends on multipath environment, number of satellites in view, satellite geometry, and ionospheric activity

⁴IEC 60945 Standard

⁵Based on a 40 second time constant

Appendix C: Using Vector G1 with NMEA 2000 Commands

NMEA 2000 cable with pinouts – we supply the cable

NMEA 2000 Messages

Table C-1 describes the NMEA 2000 messages.

Table C-1: NMEA 2000 Messages

PG Number (PGN)	Description	Level	Default Update Rate	Freq
059392	ISO Acknowledgement – Used to acknowledge the status of certain requests addressed to a specific ECU	B	On Request	On Request
059904	ISO Request – Request the transmission of a specific PGN, addressed or broadcast	B	On Request	On Request
060928	ISO Address Claim – Used to identify to other ECUs the address claimed by an ECU	B	On Request	On Request
126996	Product Information – NMEA 2000® Database Version Supported, Manufacturer’s Product Code, NMEA 2000® Certification Level, Load Equivalency Number, and other product-specific information	B	On Request	On Request
126464	Receive/Transmit PGNs group function -The Transmit / Receive PGN List Group type of function is defined by first field. The message will be a Transmit or Receive PGN List group function.	B	On Request	On Request
126992	System Time- The purpose of this PGN is twofold: To provide a regular transmission of UTC time and date. To provide synchronism for measurement data.	B	1000	1
127250	Vessel Heading - Heading sensor value with a flag for True or Magnetic. If the sensor value is Magnetic, the deviation field can be used to produce a Magnetic heading, and the variation field can be used to correct the Magnetic heading to produce a True heading.	B	100	10
127251	Rate of Turn - Rate of Turn is the rate of change of the Heading.	B	100	10

Table C-1: NMEA 2000 Messages

PG Number (PGN)	Description	Level	Default Update Rate	Freq
127257	Attitude -is PGN provides a single transmission that describes the position of a vessel relative to both horizontal and vertical planes. This would typically be used for vessel stabilization, vessel control and onboard platform stabilization.	B	1000	1
127258	Magnetic Variation - Message for transmitting variation. The message contains a sequence number to allow synchronization of other messages such as Heading or Course over Ground. The quality of service and age of service are provided to enable recipients to determine an appropriate level of service if multiple transmissions exist.		1000	1
128259	Speed - The purpose of this PGN is to provide a single transmission that describes the motion of a vessel.	B	1000	1
129025	Position, Rapid Update - This PGN provides latitude and longitude referenced to WGS84. Being defined as single frame message, as opposed to other PGNs that include latitude and longitude and are defined as fast or multi-packet, this PGN lends itself to being transmitted more frequently without using up excessive bandwidth on the bus for the benefit of receiving equipment that may require rapid position updates.	B	100	10
129026	COG & SOG, Rapid Update - This PGN is a single frame PGN that provides Course Over Ground (COG) and Speed Over Ground (SOG).	B	250	4

Table C-1: NMEA 2000 Messages

PG Number (PGN)	Description	Level	Default Update Rate	Freq
129027	Position Delta, High Precision Rapid Update- The "Position Delta, High Precision Rapid Update" Parameter Group is intended for applications where very high precision and very fast update rates are needed for position data. This PGN can provide delta position changes down to 1 millimeter with a delta time period accurate to 5 milliseconds.	B	100	10
129028	Altitude Delta, High Precision Rapid Update - The "Altitude Delta, High Precision Rapid Update" Parameter Group is intended for applications where very high precision and very fast update rates are needed for altitude and course over ground data. This PG can provide delta altitude changes down to 1 millimeter, a change in direction as small as 0.0057 degrees, and with a delta time period accurate to 5 milliseconds.	B	100	10
129029	GNSS Position Data- This PGN conveys a comprehensive set of Global Navigation Satellite System (GNSS) parameters, including position information.	B	1000	1
129033	Time & Date - This PGN has a single transmission that provides: UTC time, UTC Date and Local Offset.	B	1000	1
129538	GNSS Control Status - GNSS common satellite receiver parameter status.	B	On Request	On Request
129539	GNSS DOPs - This PGN provides a single transmission containing GNSS status and dilution of precision components (DOP) that indicate the contribution of satellite geometry to the overall positioning error. There are three DOP parameters reported, horizontal (HDOP), Vertical (VDOP) and time (TDOP).	B	1000	1

Table C-1: NMEA 2000 Messages

PG Number (PGN)	Description	Level	Default Update Rate	Freq
129540	GNSS Sats in View - GNSS information on current satellites in view tagged by sequence ID. Information includes PRN, elevation, azimuth, SNR, defines the number of satellites; defines the satellite number and the information.	B	1000	1

Appendix D: Interfacing to ComNav Autopilot and Compass Display

Commander P2 or Admiral P3 and Navigation G1

Figure 1 shows the typical connections used with a ComNav Commander P2 Autopilot System (an Admiral P3 would be wired identically), a Navigator G2 GPS Compass Display System, and a generic Chartplotter or other type of Navigation System.

Note: this wiring information assumes that the G1 is in its factory-default configuration: Autopilot data on Port A. Port C defaults to NMEA 2000. Use ComNav toolkit software to convert to 0183 if required. (CD included)

The wiring from G1 to commander P2 and Admiral P3, SPU J9 - NAV I/O connector, is as follows:

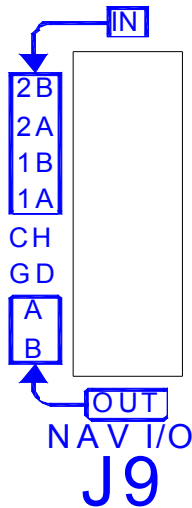

J9 Pin	Wire Color	Signal	Signal	Data Carried
IN-2B	user-supplied ①	RS-422, 'B'	from Chartplotter, etc.	Navigation: Waypoints, Position, etc.
IN-2A	user-supplied ①	RS-422, 'A'		
IN-1B	Yellow	Port A, Tx	from G1, Port A* Transmit	Heading, Speed
IN-1A	White	Signal ground		
OUT-1A	user-supplied ①	RS-422, 'A'	to Chartplotter, etc.	Autopilot status
OUT-1B	user-supplied ①	RS-422, 'B'		

* Port C when configured to NMEA 0183

Table 3 - Commander P2 Connection Detail

In addition to the above wiring, the Commander P2 must be configured to look for both heading and speed data from its NAV1 input port, and for Navigation data from NAV2; for details, see the respective Source selection descriptions for the Standby, Auto & Nav menus, in the P2 Installation & Operation manual.

Other ComNav Autopilot Systems

All other ComNav autopilots require the use of an optional Sine-Cosine Interface Box (PN 21010004), with matching interface cable (PN 31110023 or 31110051), to use them with a Vector G1.

See the instructions included with the Sine-Cosine Box for wiring and setup information. Note that the G1's Port C Tx and the signal ground wires are the ones to be connected to the Converter.

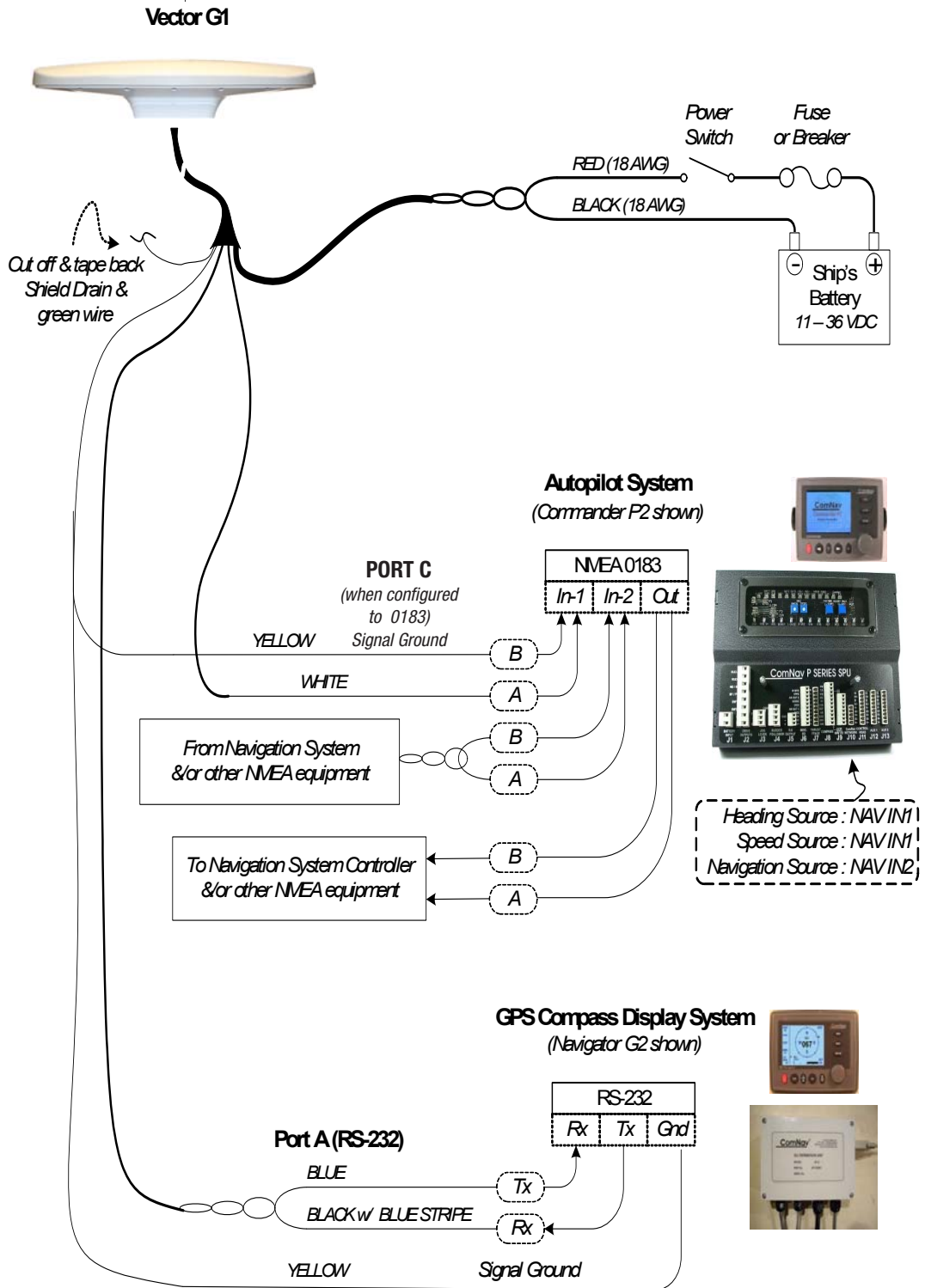

Figure 1 - Typical Wiring Diagram of a Vector G1 System with Autopilot & Compass Display

Interfacing to a PC

Figure 2 shows the typical connections when using a PC to perform "Navigation display &/or control" functions or to use the ComNav Toolkit to configure the G1.

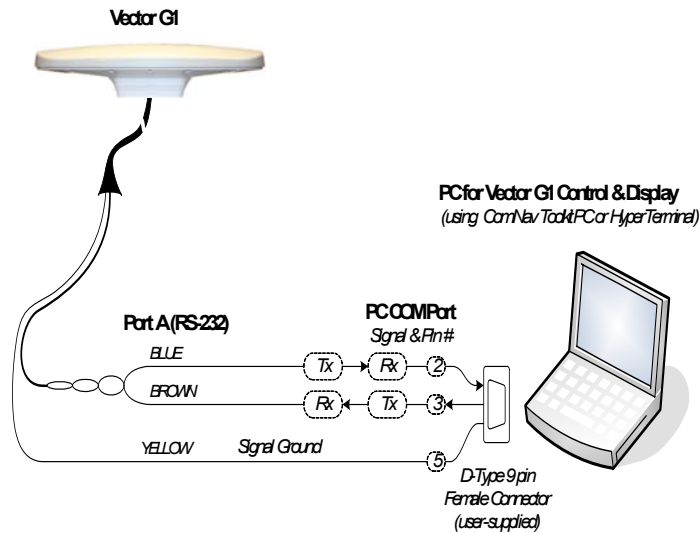

Figure 2 - Typical Wiring with a PC for Vector G1 Control & Display

Interfacing to other NMEA 0183 devices

Many NMEA 0183 devices can accept RS 232 input signal. For these devices, you can connect the G1 RS 232 Rx of Port A or Port C to NMEA 0183 "A" and the G1 signal ground to NMEA 0183 "B". However, there are devices that only accept RS 422 signal. In such situation, a standard RS 232 RS 422 Converter can be used to interface the G1 to an NMEA 0183 devices.

End User License Agreement

IMPORTANT - This is an agreement (the "Agreement") between you, the end purchaser ("Licensee") and ComNav Marine Ltd. ("ComNav") which permits Licensee to use the ComNav software (the "Software") that accompanies this Agreement. This Software may be licensed on a standalone basis or may be embedded in a Product. Please read and ensure that you understand this Agreement before installing or using the Software Update or using a Product.

In this agreement any product that has Software embedded in it at the time of sale to the Licensee shall be referred to as a "Product". As well, in this Agreement, the use of a Product shall be deemed to be use of the Software which is embedded in the Product.

BY INSTALLING OR USING THE SOFTWARE UPDATE OR THE PRODUCT, LICENSEE THEREBY AGREES TO BE LEGALLY BOUND BY THE TERMS OF THIS AGREEMENT. IF YOU DO NOT AGREE TO THESE TERMS, (I) DO NOT INSTALL OR USE THE SOFTWARE, AND (II) IF YOU ARE INSTALLING AN UPDATE TO THE SOFTWARE, DO NOT INSTALL THE UPDATE AND PROMPTLY DESTROY IT.

COMNAV PROVIDES LIMITED WARRANTIES IN RELATION TO THE SOFTWARE. AS WELL, THOSE WHO USE THE EMBEDDED SOFTWARE DO SO AT THEIR OWN RISK. YOU SHOULD UNDERSTAND THE IMPORTANCE OF THESE AND OTHER LIMITATIONS SET OUT IN THIS AGREEMENT BEFORE INSTALLING OR USING THE SOFTWARE OR THE PRODUCT.

1. **LICENSE.** ComNav hereby grants to Licensee a non-transferable and non-exclusive license to use the Software as embedded in a Product and all Updates (collectively the "Software"), solely in binary executable form.
2. **RESTRICTIONS ON USE.** Licensee agrees that Licensee and its employees will not directly or indirectly, in any manner whatsoever:
 - a. install or use more copies of the Software than the number of copies that have been licensed;
 - b. use or install the Software in connection with any product other than the Product the Software was intended to be used or installed on as set out in the documentation that accompanies the Software.
 - c. copy any of the Software or any written materials for any purpose except as part of Licensee's normal backup processes;
 - d. modify or create derivative works based on the Software;
 - e. sub-license, rent, lease, loan or distribute the Software;
 - f. permit any third party to use the Software;
 - g. use or operate Product for the benefit of any third party in any type of service outsourcing, application service, provider service or service bureau capacity;
 - h. reverse engineer, decompile or disassemble the Software or otherwise reduce it to a human perceivable form;
 - i. Assign this Agreement or sell or otherwise transfer the Software to any other party except as part of the sale or transfer of the whole Product.
3. **UPDATES.** At ComNav's discretion ComNav may make Updates available to Licensee. An update ("**Update**") means any update to the Software that is made available to Licensee including warranty corrections, enhancements and other modifications. Licensee may access, download and install Updates during the Warranty Period only. All Updates that Licensee downloads, installs or uses shall be deemed to be Software and subject to this Agreement. ComNav reserves the right to modify the Product without any obligation to notify, supply or install any improvements or alterations to existing Software.
4. **SUPPORT.** ComNav may make available directly or through its authorized dealers telephone and email support for the Software. Contact ComNav to find the authorized dealer near you. As well, ComNav may make available user and technical documentation regarding the Software. ComNav reserves the right to reduce and limit access to such support at any time.
5. **BACKUPS AND RECOVERY.** Licensee shall back-up all data used, created or stored by the Software on a regular basis as necessary to enable proper recovery of the data and related systems and processes in the event of a malfunction in the Software or any loss or corruption of data caused by the Software. Licensee shall assume all risks of loss or damage for any failure to comply with the foregoing.
6. **OWNERSHIP.** The Licensee understands that the Licensee does NOT own rights, title and interest in and to the Software and related materials, including intellectual property rights. The Software is licensed to Licensee, not sold.
7. **TRADEMARKS.** "ComNav" and the associated logos are trademarks of ComNav. Other trademarks are the property of their respective owners. Licensee may not use any of these trademarks without the consent of their respective owners.
8. **LIMITED WARRANTY.** ComNav warrants solely to the Licensee, subject to the exclusions and procedures set forth herein below, that for a period of one (1) year from the original date of purchase of the Product in which it is embedded (the "Warranty Period"), the Software, under normal use and maintenance, will conform in all material respects to the documentation provided with the Software and any media will be free of defects in materials and workmanship. For any Update, ComNav warrants, for 90 days from performance or delivery, or for the balance of the original Warranty Period, whichever is greater, that the Update, under normal use and maintenance, will conform in all material respects to the documentation provided with the Update and any media will be free of defects in materials and workmanship. Notwithstanding the foregoing, ComNav does not warrant that the Software will meet Licensee's requirements or that its operation will be error free.
9. **WARRANTY EXCLUSIONS.** The warranty set forth in Section (8) will not apply to any deficiencies caused by (a) the Product not being used as described in the documentation supplied to Licensee, (b) the Software having been altered, modified or converted in any way by anyone other than ComNav or approved by ComNav, (c) any malfunction of Licensee's equipment or other software, or (d) damage occurring in transit or due to any accident, abuse, misuse, improper installation, lightning (or other

electrical discharge) or neglect other than that caused by ComNav. ComNav GPS does not warrant or guarantee the precision or accuracy of positions obtained when using the Software (whether standalone or embedded in a Product). The Product and the Software is not intended and should not be used as the primary means of navigation or for use in safety of life applications. The potential positioning and navigation accuracy obtainable with the Software as stated in the Product or Software documentation serves to provide only an estimate of achievable accuracy based on specifications provided by the US Department of Defense for GPS positioning and DGPS service provider performance specifications, where applicable.

10. **WARRANTY DISCLAIMER.** EXCEPT AS EXPRESSLY SET OUT IN THIS AGREEMENT, COMNAV MAKES NO REPRESENTATION, WARRANTY OR CONDITION OF ANY KIND TO LICENSEE, WHETHER VERBAL OR WRITTEN AND HEREBY DISCLAIMS ALL REPRESENTATIONS, WARRANTIES AND CONDITIONS OF ANY KIND INCLUDING FITNESS FOR A PARTICULAR PURPOSE, MERCHANTABILITY, ACCURACY, RELIABILITY OR THAT THE USE OF THE SOFTWARE WILL BE UNINTERRUPTED OR ERROR-FREE AND HEREBY DISCLAIMS ALL REPRESENTATIONS, WARRANTIES AND CONDITIONS ARISING AS A RESULT OF CUSTOM, USAGE OR TRADE AND THOSE ARISING UNDER STATUTE.
11. **LIMITS ON WARRANTY DISCLAIMER.** Some jurisdictions do not allow the exclusion of implied warranties or conditions, so some of the above exclusions may not apply to Licensee. In that case, any implied warranties or conditions which would then otherwise arise will be limited in duration to ninety (90) days from the date of the license of the Software or the purchase of the Product. The warranties given herein give Licensee specific legal rights and Licensee may have other rights which may vary from jurisdiction to jurisdiction.
12. **CHANGE TO WARRANTY.** No employee or agent of ComNav is authorized to change the warranty provided or the limitation or disclaimer of warranty provisions. All such changes will only be effective if pursuant to a separate agreement signed by senior officers of the respective parties.
13. **WARRANTY CLAIM.** In the event Licensee has a warranty claim Licensee must first check for and install all Updates that are made available. The warranty will not otherwise be honored. Proof of purchase may be required. ComNav does not honor claims asserted after the end of the Warranty Period.
14. **LICENSEE REMEDIES.** In all cases which involve a failure of the Software to conform in any material respect to the documentation during the Warranty Period or a breach of a warranty, ComNav's sole obligation and liability, and Licensee's sole and exclusive remedy, is for ComNav, at ComNav's option, to (a) repair the Software, (b) replace the Software with software conforming to the documentation, or (c) if ComNav is unable, on a reasonable commercial basis, to repair the Software or to replace the Software with conforming software within ninety (90) days, to terminate this Agreement and thereafter Licensee shall cease using the Software. ComNav will also issue a refund for the price paid by Licensee less an amount on account of amortization, calculated on a straight-line basis over a deemed useful life of three (3) years.
15. **LIMITATION OF LIABILITY.** IN NO EVENT WILL COMNAV BE LIABLE TO LICENSEE FOR ANY INCIDENTAL, CONSEQUENTIAL, SPECIAL OR INDIRECT DAMAGES INCLUDING ARISING IN RELATION TO ANY LOSS OF DATA, INCOME, REVENUE, GOODWILL OR ANTICIPATED SAVINGS EVEN IF COMNAV HAS BEEN INFORMED OF THE POSSIBILITY OF SUCH LOSS OR DAMAGE. FURTHER, IN NO EVENT WILL COMNAV'S TOTAL CUMULATIVE LIABILITY HEREUNDER, FROM ALL CAUSES OF ACTION OF ANY KIND, EXCEED THE TOTAL AMOUNT PAID BY LICENSEE TO COMNAV TO PURCHASE THE PRODUCT. THIS LIMITATION AND EXCLUSION APPLIES IRRESPECTIVE OF THE CAUSE OF ACTION, INCLUDING BUT NOT LIMITED TO BREACH OF CONTRACT, NEGLIGENCE, STRICT LIABILITY, TORT, BREACH OF WARRANTY, MISREPRESENTATION OR ANY OTHER LEGAL THEORY AND WILL SURVIVE A FUNDAMENTAL BREACH.
16. **LIMITS ON LIMITATION OF LIABILITY.** Some jurisdictions do not allow for the limitation or exclusion of liability for incidental or consequential damages, so the above limitation or exclusion may not apply to Licensee and Licensee may also have other legal rights which may vary from jurisdiction to jurisdiction.
17. **BASIS OF BARGAIN.** Licensee agrees and acknowledges that ComNav has set its prices and the parties have entered into this Agreement in reliance on the limited warranties, warranty disclaimers and limitations of liability set forth herein, that the same reflect an agreed-to allocation of risk between the parties (including the risk that a remedy may fail of its essential purpose and cause consequential loss), and that the same forms an essential basis of the bargain between the parties. Licensee agrees and acknowledges that ComNav would not have been able to sell the Product at the amount charged on an economic basis without such limitations.
18. **PROPRIETARY RIGHTS INDEMNITY.** ComNav shall indemnify, defend and hold harmless Licensee from and against any and all actions, claims, demands, proceedings, liabilities, direct damages, judgments, settlements, fines, penalties, costs and expenses, including royalties and attorneys' fees and related costs, in connection with or arising out of any actual infringement of any third party patent, copyright or other intellectual property right by the Software or by its use, in accordance with this Agreement and documentation, PROVIDED THAT: (a) ComNav has the right to assume full control over any action, claim, demand or proceeding, (b) Licensee shall promptly notify ComNav of any such action, claim, demand, or proceeding, and (c) Licensee shall give ComNav such reasonable assistance and tangible material as is reasonably available to Licensee for the defense of the action, claim, demand or proceeding. Licensee shall not settle or compromise any of same for which ComNav has agreed to assume responsibility without ComNav's prior written consent. Licensee may, at its sole cost and expense, retain separate counsel from the counsel utilized or retained by ComNav.
19. **INFRINGEMENT.** If use of the Software may be enjoined due to a claim of infringement by a third party then, at its sole discretion and expense, ComNav may do one of the following: (a) negotiate a license or other agreement so that the Product is no longer subject to such a potential claim, (b) modify the Product so that it becomes non-infringing, provided such modification can

be accomplished without materially affecting the performance and functionality of the Product, (c) replace the Software, or the Product, with non-infringing software, or product, of equal or better performance and quality, or (d) if none of the foregoing can be done on a commercially reasonable basis, terminate this license and Licensee shall stop using the Product and ComNav shall refund the price paid by Licensee less an amount on account of amortization, calculated on a straight-line basis over a deemed useful life of three (3) years.

The foregoing sets out the entire liability of ComNav and the sole obligations of ComNav to Licensee in respect of any claim that the Software or its use infringes any third party rights.

20. **INDEMNIFICATION.** Except in relation to an infringement action, Licensee shall indemnify and hold ComNav harmless from any and all claims, damages, losses, liabilities, costs and expenses (including reasonable fees of lawyers and other professionals) arising out of or in connection with Licensee's use of the Product, whether direct or indirect, including without limiting the foregoing, loss of data, loss of profit or business interruption.
21. **TERMINATION.** Licensee may terminate this Agreement at any time without cause. ComNav may terminate this Agreement on 30 days notice to Licensee if Licensee fails to materially comply with each provision of this Agreement unless such default is cured within the 30 days. Any such termination by a party shall be in addition to and without prejudice to such rights and remedies as may be available, including injunction and other equitable remedies. Upon receipt by Licensee of written notice of termination from ComNav or termination by Licensee, Licensee shall at the end of any notice period (a) cease using the Software; and (b) return to ComNav (or destroy and provide a certificate of a Senior Officer attesting to such destruction) the Software and all related material and any magnetic or optical media provided to Licensee. The provisions of Sections 6), 7), 8), 9), 10), 15), 21), 26) and 27) herein shall survive the expiration or termination of this Agreement for any reason.
22. **EXPORT RESTRICTIONS.** Licensee agrees that Licensee will comply with all export control legislation of Canada, the United States, Australia and any other applicable country's laws and regulations, whether under the Arms Export Control Act, the International Traffic in Arms Regulations, the Export Administration Regulations, the regulations of the United States Departments of Commerce, State, and Treasury, or otherwise as well as the export control legislation of all other countries.
23. **PRODUCT COMPONENTS.** The Product may contain third party components. Those third party components may be subject to additional terms and conditions. Licensee is required to agree to those terms and conditions in order to use the Product.
24. **FORCE MAJEURE EVENT.** Neither party will have the right to claim damages as a result of the other's inability to perform or any delay in performance due to unforeseeable circumstances beyond its reasonable control, such as labor disputes, strikes, lockouts, war, riot, insurrection, epidemic, Internet virus attack, Internet failure, supplier failure, act of God, or governmental action not the fault of the non-performing party.
25. **FORUM FOR DISPUTES.** The parties agree that the courts located in Vancouver, BC, Canada and the courts of appeal there from will have exclusive jurisdiction to resolve any disputes between Licensee and ComNav concerning this Agreement or Licensee's use or inability to use the Software and the parties hereby irrevocably agree to attorn to the jurisdiction of those courts. Notwithstanding the foregoing, either party may apply to any court of competent jurisdiction for injunctive relief.
26. **APPLICABLE LAW.** This Agreement shall be governed by the laws of the Province of British Columbia, Canada, exclusive of any of its choice of law and conflicts of law jurisprudence.
27. **CISG.** The United Nations Convention on Contracts for the International Sale of Goods will not apply to this Agreement or any transaction hereunder.
28. **GENERAL.** This is the entire agreement between Licensee and ComNav relating to the Product and Licensee's use of the same, and supersedes all prior, collateral or contemporaneous oral or written representations, warranties or agreements regarding the same. No amendment to or modification of this Agreement will be binding unless in writing and signed by duly authorized representatives of the parties. Any and all terms and conditions set out in any correspondence between the parties or set out in a purchase order which are different from or in addition to the terms and conditions set forth herein, shall have no application and no written notice of same shall be required. In the event that one or more of the provisions of this Agreement is found to be illegal or unenforceable, this Agreement shall not be rendered inoperative but the remaining provisions shall continue in full force and effect.

Warranty Information

Limited Warranty

This Limited Warranty (the “Warranty”) covers all Vector and Navigator GPS Compass products & accessories (the “Equipment”) sold by ComNav Marine Ltd. (“ComNav”).

LIMITED ONE YEAR WARRANTY

ComNav warrants to the Purchaser, provided that the recommended installation and maintenance procedures set forth in the manual (the “Manual”) provided with the Equipment have been followed, and subject always to the other provisions of this Warranty, that the Equipment is free from defects in workmanship and materials under normal use and service for a period of one (1) year from the date of purchase of the Equipment by the Purchaser.

EXCLUSIONS

This Limited Warranty is null and void if:

1. The serial number of the Equipment has been removed, altered or mutilated;
2. Any of the anti-tamper seals covering case-screw holes, or other mechanisms for opening the Equipment’s case, have been removed, broken or otherwise tampered with;
3. There are any defects in it, or damages to it, caused by:
 - a. Faulty installation or hook-up of the Equipment;
 - b. Abuse, misuse, or any use of the Equipment in violation of the instructions set forth in the Manual;
 - c. Shipping, alterations, or incorrect and/or unauthorized service;
 - d. Accident, exposure of the Equipment to excessive heat, fire, lightning or other electrical discharge, or water immersion;
 - e. Water damage due to failure to fully fasten the plug connected into the equipment’s power/signal receptacle;
 - f. Improper or inadequate ancillary or connected equipment.

OTHER LIMITATIONS AND EXCLUSIONS

1. ComNav does not warrant or guarantee the precision or accuracy of positions, heading, or other GPS-based navigation data obtained when using the Equipment. The potential accuracy of the Equipment, as stated in the Manual, associated ComNav literature and/or Product specifications, provides only an estimate of the highest achievable accuracy based on:
 - a. Specifications provided by the US Department of Defence for GPS Positioning;
 - b. GPS Receiver specifications provided by the OEM manufacturer;
 - c. DGPS service provider performance specifications.
2. The Equipment is not intended for primary navigation or for use in safety of life applications; ComNav does not warrant or guarantee that the Equipment will perform in accordance with the requirements of such usage;
3. ComNav reserves the right to modify the Equipment without any obligation to notify, supply or install any improvements or alterations to existing Equipment.

NO OTHER WARRANTIES

THE FOREGOING WARRANTY IS EXCLUSIVE OF ALL OTHER WARRANTIES AND CONDITIONS, WHETHER WRITTEN, ORAL OR IMPLIED, ARISING BY STATUTE OR OTHERWISE, WITH RESPECT TO THE DESIGN, SALE, INSTALLATION OR USE OF THE EQUIPMENT, INCLUDING BUT NOT LIMITED TO IMPLIED WARRANTIES OR CONDITIONS OF MERCHANTABILITY AND FITNESS FOR THE ORDINARY PURPOSES FOR WHICH THE EQUIPMENT IS USED OR FITNESS FOR A PARTICULAR PURPOSE, AND ANY OTHER OBLIGATIONS ON THE PART OF COMNAV, ITS EMPLOYEES, SUPPLIERS, AGENTS, OR REPRESENTATIVES.

LIMITATION OF LIABILITY

The extent of ComNav's liability for damages of any nature to the end purchaser or any other person or entity whether in contract or tort, and whether to persons or property, shall in no case exceed, in the aggregate, the cost of correcting the defect in the equipment or, at ComNav's option, the cost of replacing the defective item. In no event will ComNav be liable for any loss of production, loss of profits, loss of use or for any special, indirect, incidental, consequential or contingent damages, even if ComNav has been advised of the possibility of such damages. Without limiting the foregoing, ComNav shall not be liable for any damages of any kind resulting from installation, use, quality, performance or accuracy of the equipment.

NOTICE OF DEFECT

The Limited Warranty will not apply with respect to any defective Equipment unless written notice of such defect is given to ComNav, by mail to the address for ComNav set forth below, or by facsimile to ComNav at 604-207-8008, and unless that written notice is received by ComNav within ten (10) days of the date upon which the defect first became known to the Purchaser.

Notices sent by mail from within North America will be deemed to be received by ComNav on the seventh (7th) day first following the date of posting. Notices sent by mail from anywhere else in the world will be deemed to be received by ComNav on the tenth (10th) day next following the date of posting. Notices sent by facsimile will be deemed to be received by ComNav on the date of transmission with appropriate answerback confirmation.

REMEDIES NOT TRANSFERABLE

The Purchaser's remedies under this Warranty apply only to the original end-user of the ComNav Equipment, being the Purchaser, and apply only to the original installation of the Equipment. The Purchaser's remedies under this Warranty are not transferable or assignable by the Purchaser to others in whole or in part.

CUSTOMER REMEDIES

1. If the Equipment, or any part thereof, proves to be defective within the warranty period, the Purchaser shall do the following:
 - a. contact ComNav, by phoning 604-207-1600, to discuss the nature of the problem and to obtain return shipping instructions for the defective Equipment;and,
 - b. prepare a detailed written statement of the nature and circumstances of the defect, to the best of the Purchaser's knowledge, and including the date of purchase of the Equipment, the place of purchase, the name and address of the installer, and the Purchaser's name, address and telephone

number, all to be sent, along with proof of purchase, to ComNav at the address set out below, and within the time limits set out above for Notice of Defect.

2. If, upon examination by ComNav, the defect is determined to result from defective workmanship or material and if the defect has occurred within the warranty period set forth above, the Equipment or the defective parts thereof shall be repaired or replaced, at ComNav's sole option, without charge, and shall be returned to the Purchaser at ComNav's expense. Return delivery will be by the most economical means. Should the Purchaser require that the Equipment be returned by a faster method, the costs incurred by the faster delivery will be pre-paid by the Purchaser.
3. No refund of the purchase price for the Equipment will be made to the Purchaser unless ComNav is unable to remedy the defect after having a reasonable number of opportunities to do so.
4. Warranty service shall be performed only by ComNav. Any attempts to remedy the defect by anyone else shall render the warranties set forth in this Warranty null and void.

CHOICE OF LAW AND JURISDICTION

This Warranty is governed by the laws of the Province of British Columbia, Canada. If the Purchaser acquired the Equipment outside of Canada, each of the parties hereto irrevocably attorn to the jurisdiction of the courts of the Province of British Columbia, Canada, and further agree to settle any dispute, controversy or claim arising out of or relating to this Limited Warranty, or the breach, termination, or invalidity of it, by arbitration under the rules of the British Columbia International Commercial Arbitration Centre ("BCICAC"). The appointing authority shall be BCICAC [or, if the BCICAC shall cease to exist, the Chief Justice of the Supreme Court of British Columbia]. BCICAC shall administer the case in accordance with BCICAC Rules. There shall be one arbitrator and the place of arbitration shall be Vancouver, British Columbia, Canada.

The United Nations Convention on Contracts for the International Sale of Goods Act, S.B.C 1990, c. 20, and any other statutory enactments of the United Nations Convention on Contracts for the International Sale of Goods do not apply to this Warranty.

ComNav Maine Ltd.
#15 - 13511 Crestwood Place
Richmond, British Columbia
V6V 2G1
Canada
www.comnav.com

WARNING

The Equipment is an aid to navigation only. It is not intended or designed to replace the person on watch. A qualified person should always be in a position to monitor the vessel's heading, and to watch for navigational hazards, and should be prepared to revert to manual steering immediately if an undesired change of heading occurs, if the heading is not maintained within reasonable limits, or when navigating in a hazardous situation.

ALWAYS REMEMBER:

WHENEVER UNDER WAY, A QUALIFIED PERSON ON WATCH IS REQUIRED BY LAW.

::